

# Kin Kei Hardware Industries Limited

E-mail: [kinkei@hardware.com.hk](mailto:kinkei@hardware.com.hk) Website: [www.hardware.com.hk](http://www.hardware.com.hk)

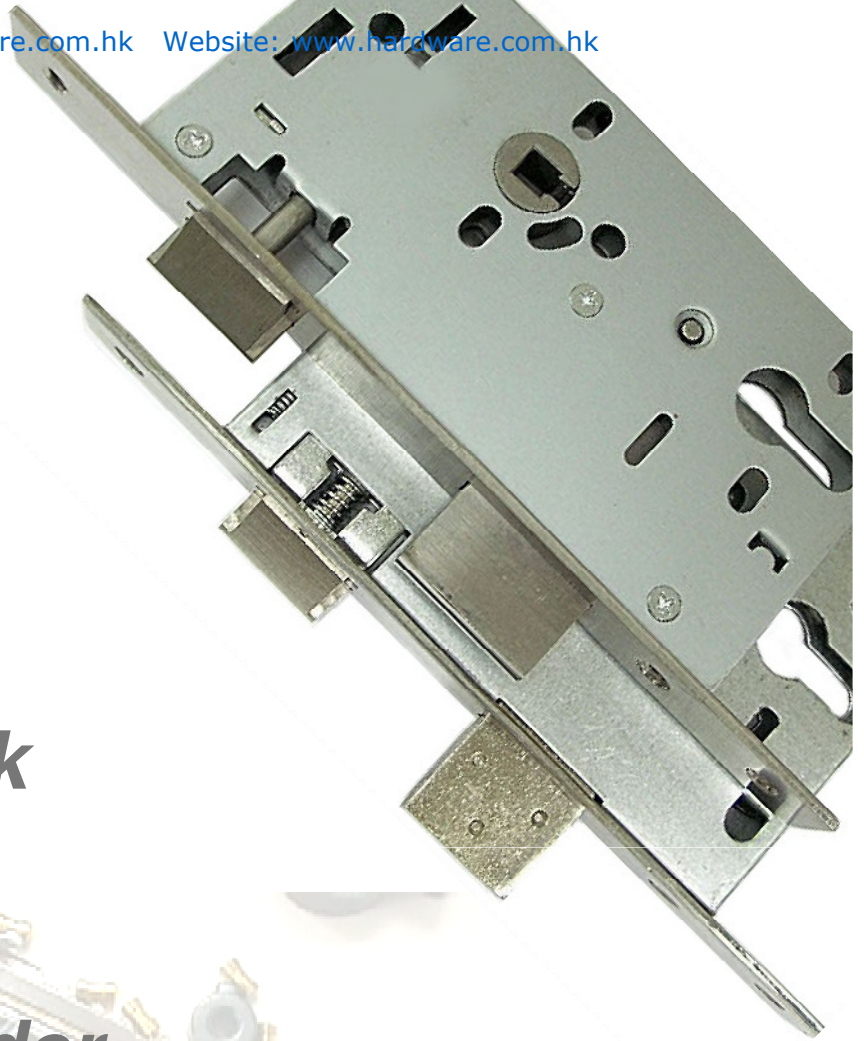

***Mortise Lock***

***Rim Cylinder***

***Euro Cylinder***

***Mortise Cylinder***



**VOLAR<sup>®</sup>**

# European Standard DIN EN 12209:2003

## Evidence of Performance

Mortise locks  
as per EN 12209 : 2003

Test report No. 207 36496

Translation of Test Report 207 36496 dated  
02 March 2009

Client

**KIN KEI HARDWARE INDUSTRIES LIMITED**

1065 KING'S ROAD,  
TAI KOO, HONG KONG  
CHINA



### Basis

EN 12209 : 2003 - Building  
hardware - Locks and latches -  
Mechanically operated locks,  
latches and locking plates - Re-  
quirements and test methods

Corrigenda to DIN EN 12209  
Ber 1:2006-06

German version  
DIN EN 12209 : 2004

### Instructions for use

This test report demonstrates  
compliance with the require-  
ments for locks as per EN  
12209 : 2003

This test report does **not** re-  
place the CE Certificate of Con-  
formity.

Observe the provisions of  
EN 12209: 2003 for marking  
and evaluation of conformity of  
construction products.

### Validity

The data and results given refer  
solely to the tested construction  
products.

### Notes on publication

The ift Guidance Sheet "Condi-  
tions and Guidance for the Use  
of ift Test Documents" applies.  
The cover sheet can be used  
as abstract.

### Contents

The report comprises a total of  
38 pages.

- 1 Object
  - 2 Procedure
  - 3 Detailed results
  - 4 Evaluation of test results
  - 5 Overall assessment
- Annex 1 (19 pages)

Construction product	Mechanically operated mortise locks
Designation	DL2922 Entrance Function, DL2922 Night Latch Function und DL2922 Passage Latch Function
Backset	60 mm
Distance	72 mm
Square spindle	8 mm
Design of forend	Flat forend [23 x 3.5 x 240] mm
Accessories	Lip strike plate (without classification)
Assembly and maintenance	As per installation and maintenance instructions by company KIN KEI HARDWARE, China

Classification of mortise locks as per EN 12209: 2003:

Lock type	Category of use	Durability	Door mass and closing force	Suitability for use on fire / smoke doors	Safety	Corrosion resis- tance	Security	Field of door appli- cation	Type of key opera- tion and locking	Type of spindle operation	Key identification
DL2922 Entrance Function	3	C	8	0	0	D	2	H	A	3	0
DL2922 Night Latch Function	3	C	8	0	0	D	-	H	0	3	0
DL2922 Passage Latch Function	3	C	8	0	0	D	-	H	0	3	0

ift Rosenheim  
7. Mai 2009

*Christian Kehr*  
Christian Kehr, Dipl.-Ing. (FH)

Head of Testing Department  
ift Centre for Pedestrian and Industrial Doors,  
Safety/Security

*A. Spreitzer*  
Alexander Spreitzer

Test engineer  
ift Centre for Pedestrian and Industrial  
Doors, Safety/Security



ift Rosenheim GmbH  
Geschäftsführer:  
Dipl.-Ing. (FH) Ulrich Sieberath  
Dr. Jochen Peichl

Theodor-Gietl-Str. 7 - 9  
D-83026 Rosenheim  
Tel.: +49 (0)8031/261-0  
Fax: +49 (0)8031/261-290  
www.ift-rosenheim.de

Sitz: 83026 Rosenheim  
AG Traunstein, HRB 14763  
Sparkasse Rosenheim  
Kto. 3822  
BLZ 711 600 00

Notified Body Nr.: 0757  
Anerkannte PUZ-Stelle: BAY 18  
Institut für  
Akustik und  
Schwingungs-  
technik  
DAP-PL 0008 39  
DAP-DE 2285 00  
TGA-DE 15-98-00  
TGA-DE 15-98-00

## Cylinder Mortise Lock

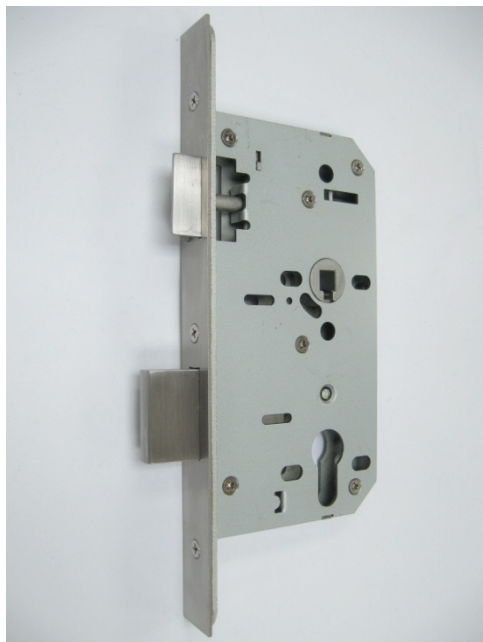

### DL2922T0 – Entrance Function

- Easy reversible latch bolt for on site adjustment without opening the lock case
- Cast stainless steel latch bolt, deadbolt and follower
- Latch operated by handle both sides or key outside
- Deadbolt operated by inside, cylinder thumb turn or key outside
- Deadbolt 2 turns
- Size: 55mm x 72mm(c.c.) / 60mm x 72mm(c.c.) / 45mm x 85mm(c.c.)
- Available with both rounded and square forend

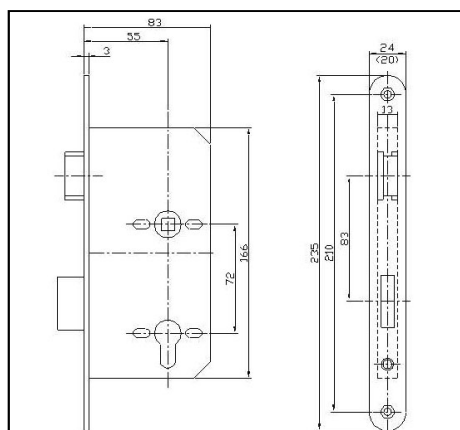

Backset 55 x c.c. 72 mm

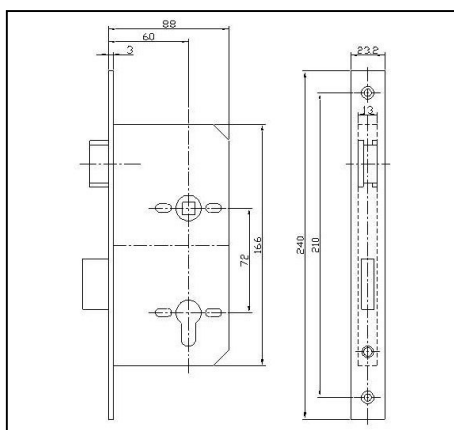

Backset 60 x c.c. 72 mm

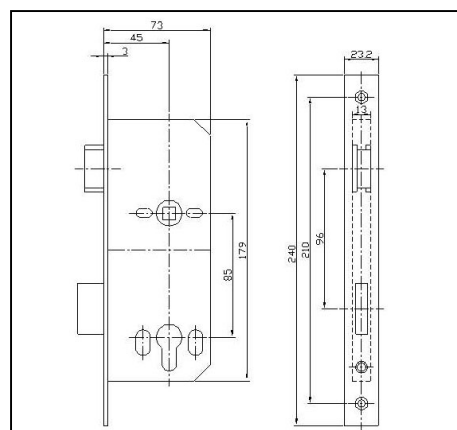

Backset 45 x c.c. 85 mm

## Cylinder Mortise Lock



### DL2922TB – Bathroom Function

- Easy reversible latch bolt for on site adjustment without opening the lock case
- Cast stainless steel latch bolt, deadbolt and follower
- Latch operated by handles either side
- Deadbolt operated by thumb turn inside and emergency release from outside
- Deadbolt single turn
- Size: 55mm x 72mm(c.c.) / 60mm x 78mm(c.c.)
- Available with both rounded and square forend

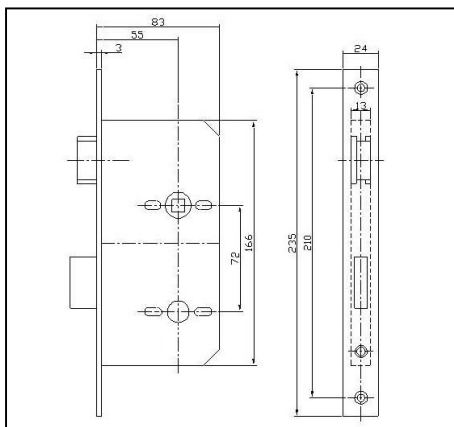

Backset 55 x c.c. 72 mm

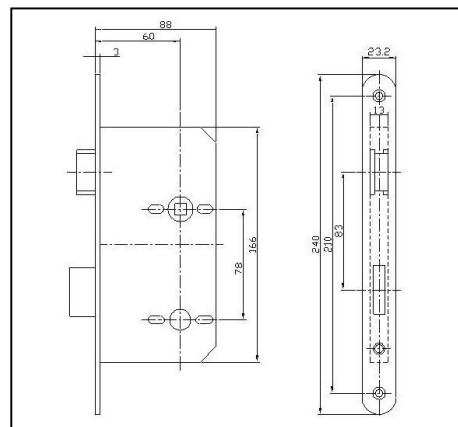

Backset 60 x c.c. 78 mm



## Cylinder Mortise Lock



### DL2922TL – Night Latch Function

- Easy reversible latch bolt for on site adjustment without opening the lock case
- Cast stainless steel latch bolt and follower
- Latch bolt operated by handle inside and cylinder key outside
- Re-locked automatically when closed
- Backset 55mm / 60mm
- Centre 72mm
- Available with both rounded and square forend

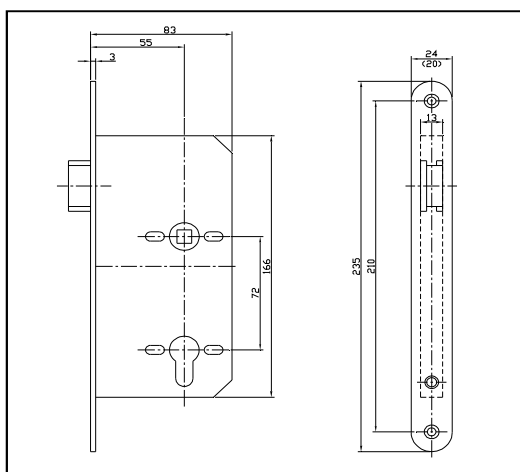

Backset 55 x c.c. 72 mm

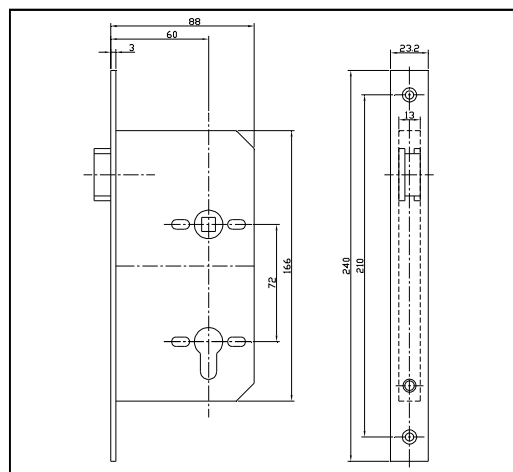

Backset 60 x c.c. 72 mm

## Cylinder Mortise Lock

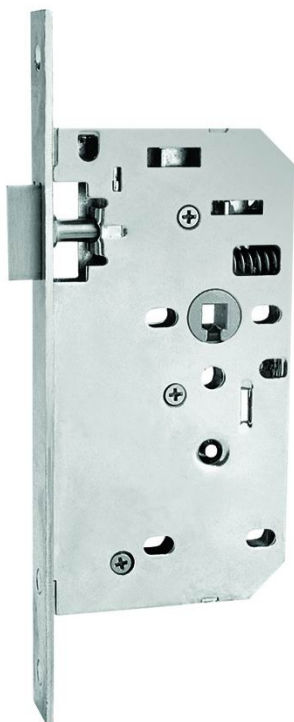

### DL2922TP – Passage Latch Function

- Easy reversible latch bolt for on site adjustment without opening the lock case
- Cast stainless steel latch bolt
- Latch bolt operated by handle either side
- For doors that do not require locking
- Backset 55mm / 60mm
- Available with both rounded and square forend

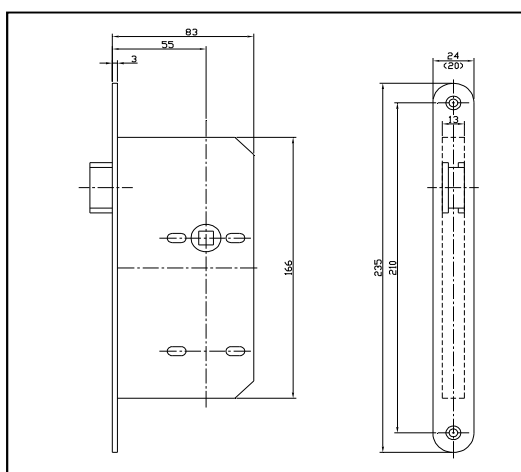

Backset 55mm

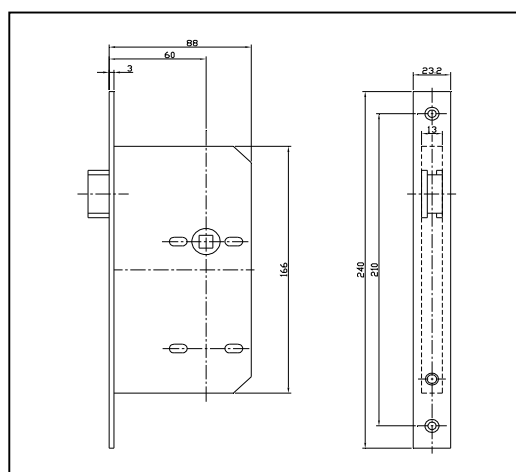

Backset 60mm

## Cylinder Mortise Lock



### DL2922TD – Deadbolt Function

- Cast stainless steel deadbolt
- Deadbolt locked or unlocked by cylinder key or cylinder thumb turn
- Deadbolt 2 turns
- Backset 55mm / 60mm
- Centre 72mm
- Available with both rounded and square forend

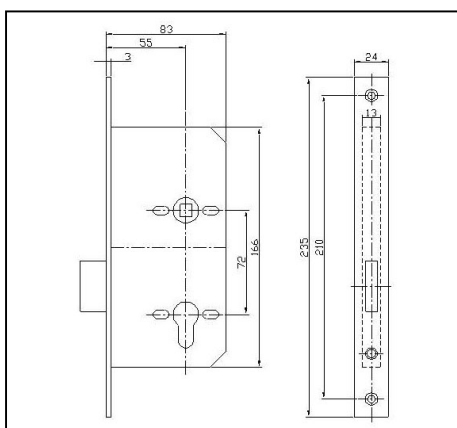

Backset 55 x c.c. 72 mm

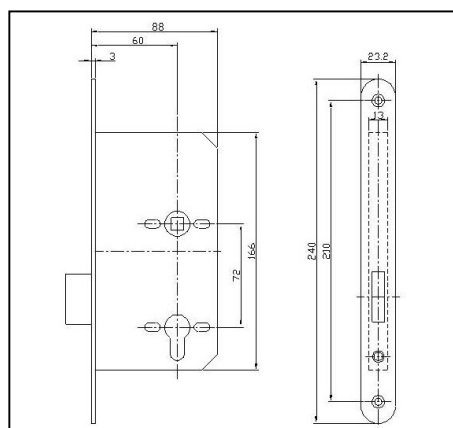

Backset 60 x c.c. 72 mm

## Cylinder Mortise Lock



### DL2922TE – Escape Deadbolt Function

- Stainless steel cast deadbolt
- Deadbolt locked or unlocked by cylinder key or cylinder thumb turn
- Deadbolt unlocked by handle from inside
- Deadbolt 2 turns
- Backset 60mm
- Centre 72mm
- Available with both rounded and square forend

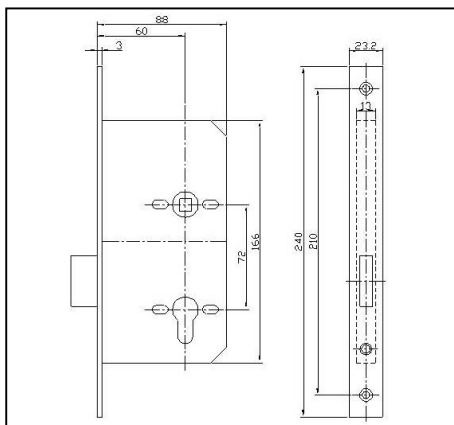

Backset 60 x c.c. 72 mm



## Cylinder Mortise Lock

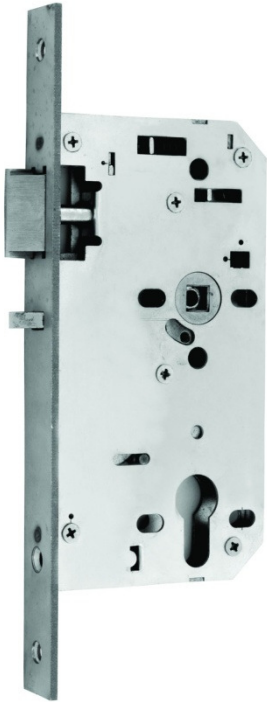

### DL2922TC – Classroom Function

- Easy reversible latch bolt for on site adjustment without opening the lock case
- Cast stainless steel latch bolt and follower
- Latch bolt operated by handle both sides when not in a locked position
- Latch bolt relocked automatically when closed
- Latch bolt deadlocked by cylinder key outside
- Latch bolt operated by handle inside all the time
- Anti-thrust bolt protects latch bolt against end pressure and retracting the latch by abuse
- Backset 60mm
- Centre 72mm
- Available with both rounded and square forend

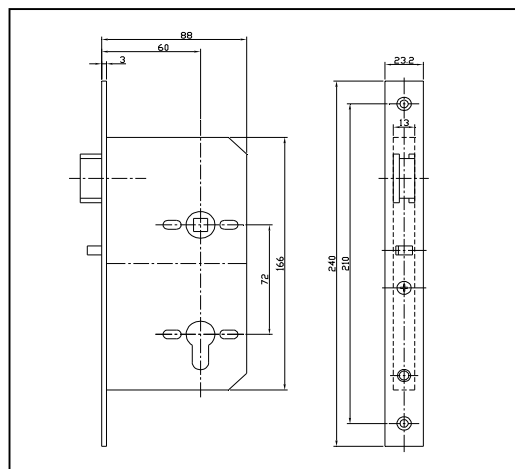

Backset 60 x c.c. 72 mm

## Cylinder Mortise Lock



### DL2922TM – Emergency Entrance Function

- Cast stainless steel latch bolt, deadbolt and 2 pcs of follower
- Latch bolt operated by handle both sides when not in a locked position
- Latch bolt and deadbolt operated by key from outside
- Latch bolt and Deadbolt unlocked simultaneously by inside handle
- Left and right handling are available
- Deadbolt 2 turns
- Backset 60mm
- Centre 72mm
- Available with both rounded and square forend

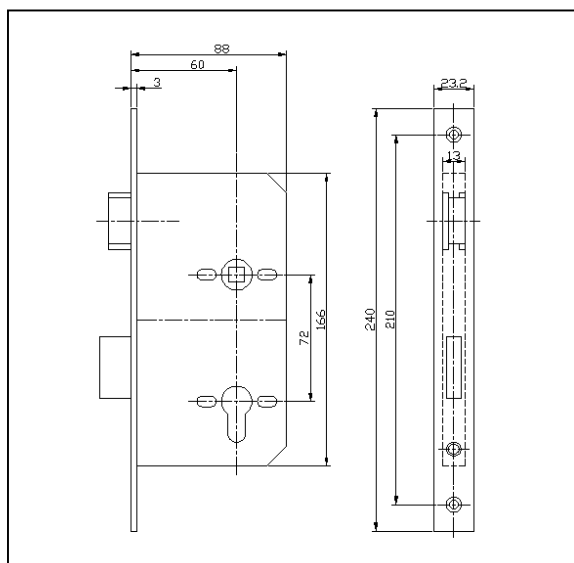

Backset 60 x c.c. 72 mm

## Cylinder Mortise Lock



### DL2922TA – Anti-thrust Night Latch Function

- Easy reversible latch bolt for on site adjustment without opening the lock case
- Cast stainless steel latch bolt and follower
- Latch bolt operated by handle inside and cylinder key outside
- Anti-thrust bolt protects latch bolt against end pressure and retracting the latch by abuse
- Backset 60mm
- Centre 72mm
- Available with both rounded and square forend

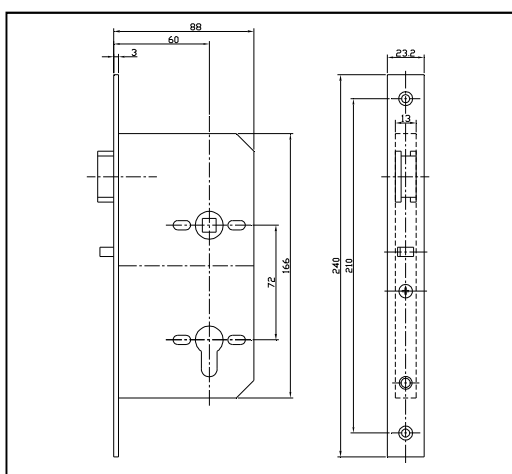

Backset 60 x c.c. 72 mm

## Cylinder Mortise Lock



### DL2974 – Entrance Function

- Easy reversible latch bolt for on site adjustment without opening the lock case
- Brass latch , steel deadbolt and follower
- Latch operated by handle either side
- Deadbolt operated by thumb turn inside and cylinder key outside
- Deadbolt single turn
- Size: 60mm x 72mm(c.c.)
- Zinc plated or painted lock case are available
- Stainless steel forend and striker
- Available with both rounded and square forend

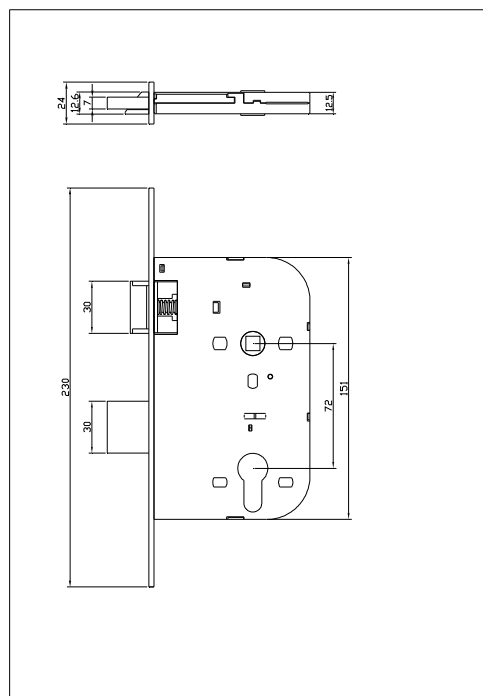

Backset 60 x c.c. 72 mm



## Cylinder Mortise Lock



### DL2975 – Night Latch Function

- Easy reversible latch bolt for on site adjustment without opening the lock case
- Brass latch and steel follower
- Latch bolt operated by handle side and cylinder key outside
- Re-locked automatically when closed
- Size: 60 x 72mm(c.c.)
- Zinc plated and painted lock case are available
- Stainless steel forend and striker
- Available with both rounded and square forend

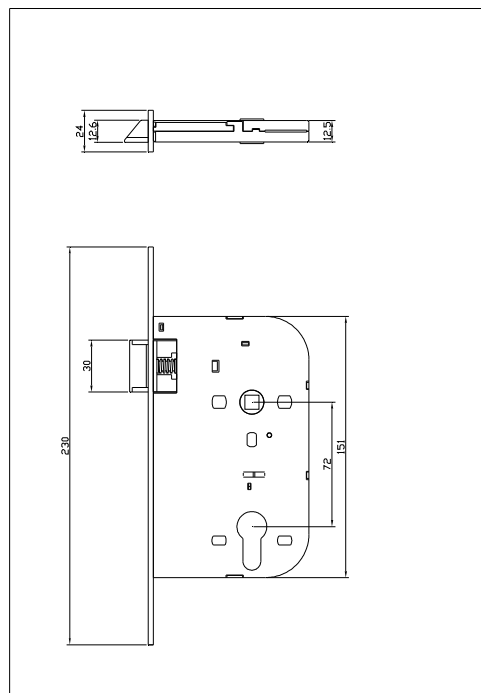

Backset 60 x c.c. 72 mm

## Cylinder Mortise Lock



### DL2976 – Passage Latch Function

- Easy reversible latch bolt for on site adjustment without opening the lock case
- Brass latch and steel follower
- Latch bolt operated by handle either side
- For doors that do not require locking
- Backset 60mm
- Zinc plated and painted lock case are available
- Stainless steel forend and striker
- Available with both rounded and square forend

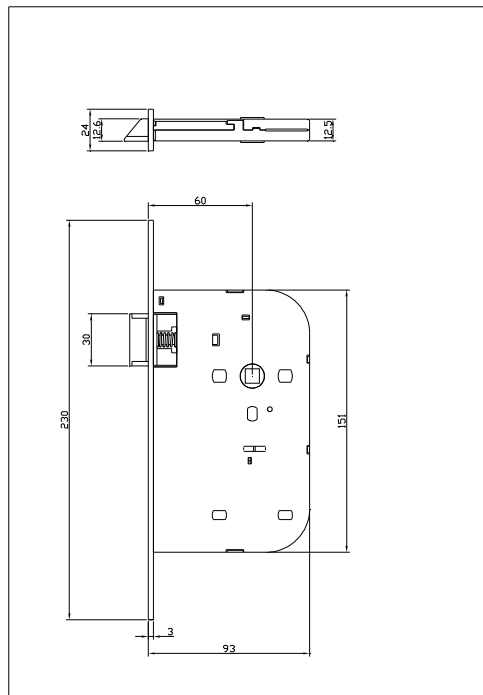

Backset 60 mm

## Cylinder Mortise Lock



### DL2977 – Bathroom Function

- Easy reversible latch bolt for on site adjustment without opening the lock case
- Brass latch, steel deadbolt and follower
- Latch operated by handles either side
- Deadbolt operated by thumb turn inside and emergency release from outside
- Deadbolt 2 turns
- Size: 60mm x 72mm(c.c.)
- Zinc plated and painted lock case available
- Stainless steel forend and striker
- Available with both rounded and square forend

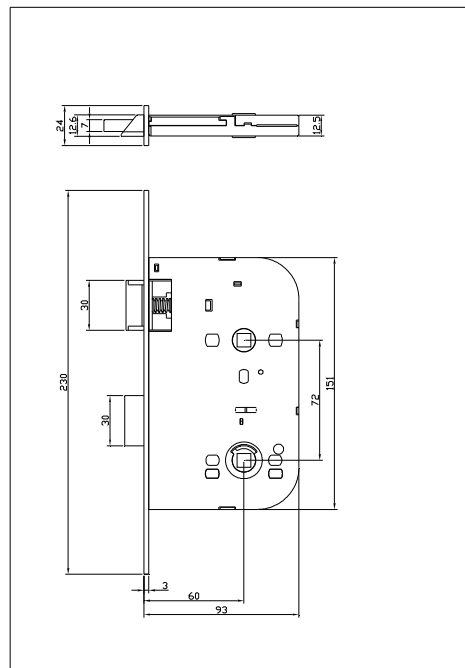

Backset 60 x c.c. 72 mm

## Cylinder Mortise Lock



### DL2978 – Deadbolt Function

- Steel deadbolt
- Deadbolt locked or unlocked by cylinder key or cylinder thumb turn
- Deadbolt 2 turns
- Backset 60mm
- Centre 72mm
- Zinc plated or painted lock case are available
- Available with both rounded and square forend

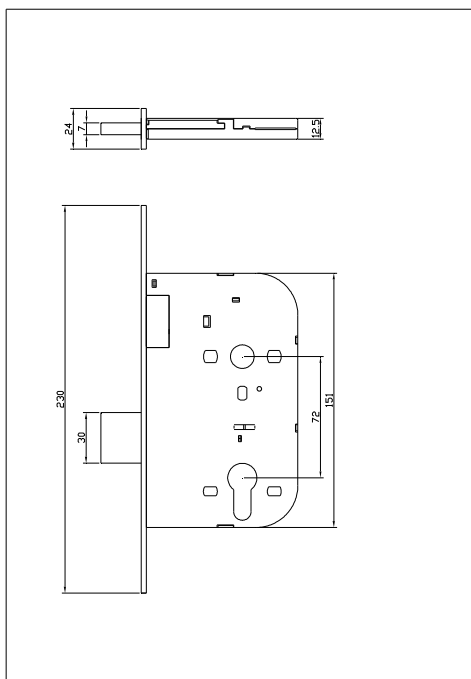

Backset 60 x c.c. 72 mm



## Cylinder Mortise Lock



### DL3491 – Entrance Function

- Easy reversible latch bolt for on site adjustment without opening the lock case
- Brass latch , steel deadbolt and follower
- Latch operated by handle either side, cylinder key and thumb turn both side
- Deadbolt operated by thumb turn inside and cylinder key outside
- Deadbolt 2 turns
- Backset 25mm / 35mm
- Centre 85mm
- Stainless steel forend and striker
- Available with both rounded and square forend

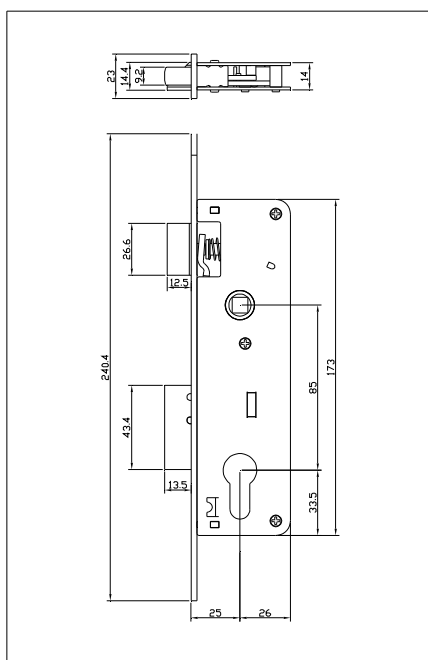

Backset 25 x c.c. 85 mm

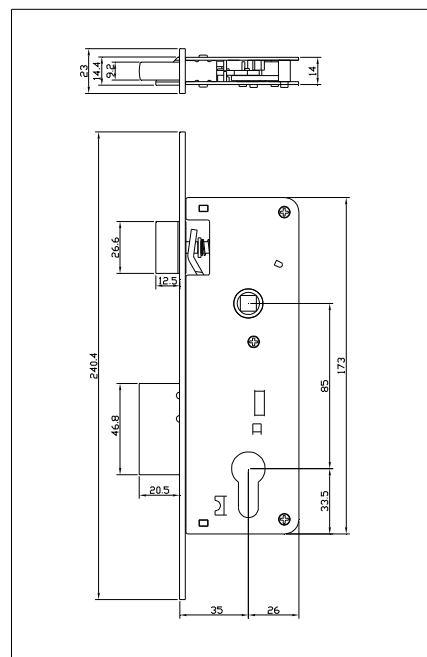

Backset 35 x c.c. 85 mm

## Cylinder Mortise Lock



### DL2568 – 3 Levers Mortise Lock

- Easy reversible latch bolt for on site adjustment without opening the lock case
- Brass latch and deadbolt
- Brass forend and steel lock case
- 3 levers
- Lock case size 2-1/2" or 3"
- 2 zinc alloy keys

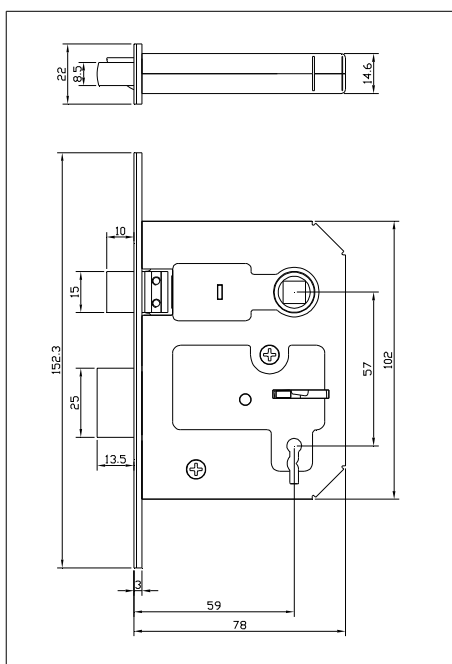

Backset 59 x c.c. 57 mm

## Cylinder Mortise Lock

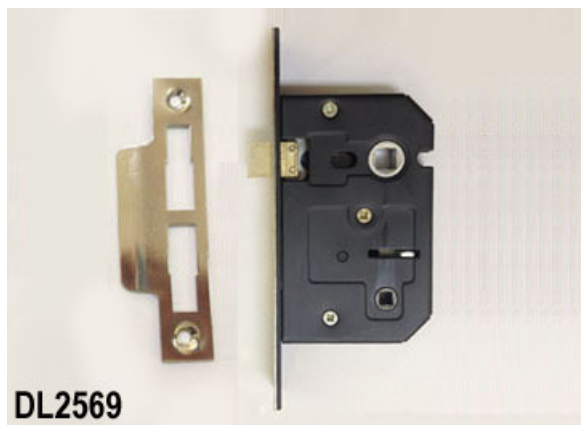

### DL2569 – Mortise Lock

- Brass / Zinc alloy latch and deadbolt
- Steel forend and steel lock case
- Lock case size 2-1/2" or 3"

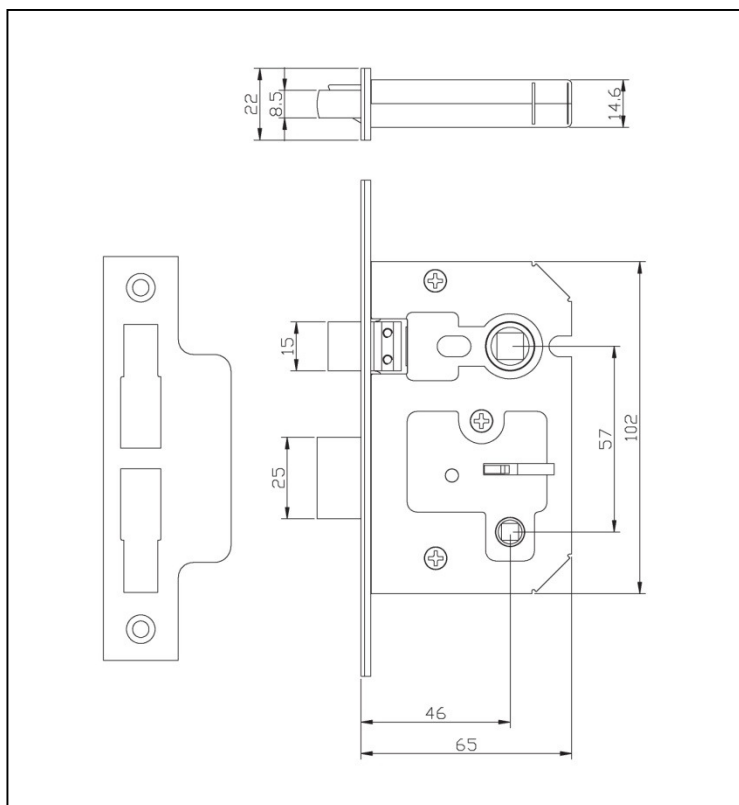

Backset 46 x c.c. 57 mm

## Cylinder Mortise Lock



### DL3768 – 5 Levers Sash Lock

- Easy reversible latch bolt for on site adjustment without opening the lock case
- Brass latch and deadbolt
- Steel forend and steel lock case
- 5 levers
- Lock case size 2-1/2" or 3"
- Backset 44mm
- Centre 57mm
- 2 brass keys
- Brass plated / Chrome plated / Nickel plated forend are available

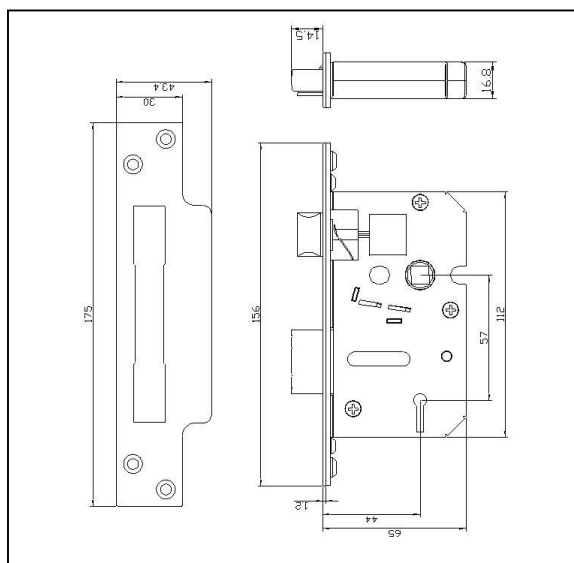

Backset 44 x c.c. 57 mm



## Cylinder Mortise Lock

**DL3771**

### DL3771 – 3 Levers Sash Lock

- Easy reversible latch bolt for on site adjustment without opening the lock case
- Brass latch and deadbolt
- Steel forend and steel lock case
- 3 levers
- Lock case size 2-1/2" or 3"
- Backset 57mm
- Centre 57mm
- 2 zinc alloy keys
- Brass plated / Chrome plated / Nickel plated forend are available

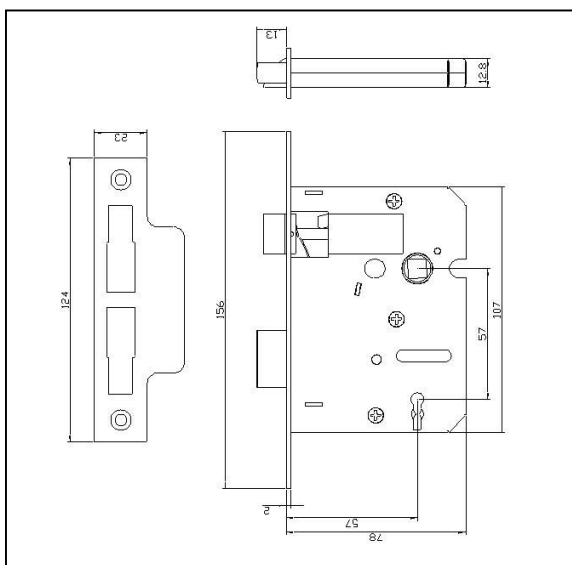

Backset 57 x c.c. 57 mm

## Cylinder Mortise Lock



### DL3558 – 5 Levers Sash Lock

- Easy reversible latch for on site adjustment without opening lock case
- Brass latch & deadbolt
- Brass forend & steel lock case
- 5 levers
- Lock case size 2-1/2"
- 2 brass keys

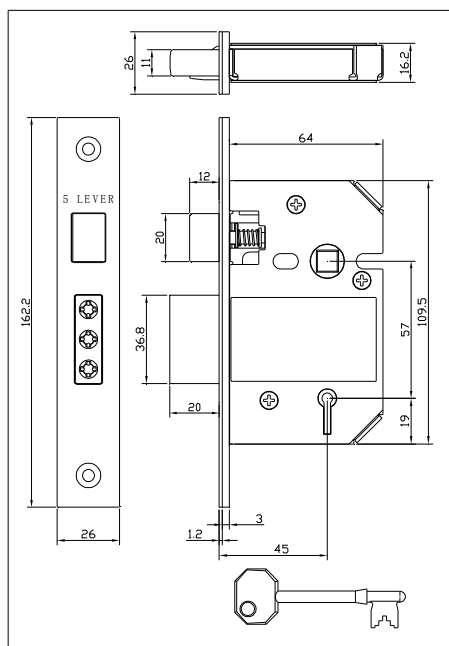

Backset 45 x c.c. 57 mm

## Cylinder Mortise Lock

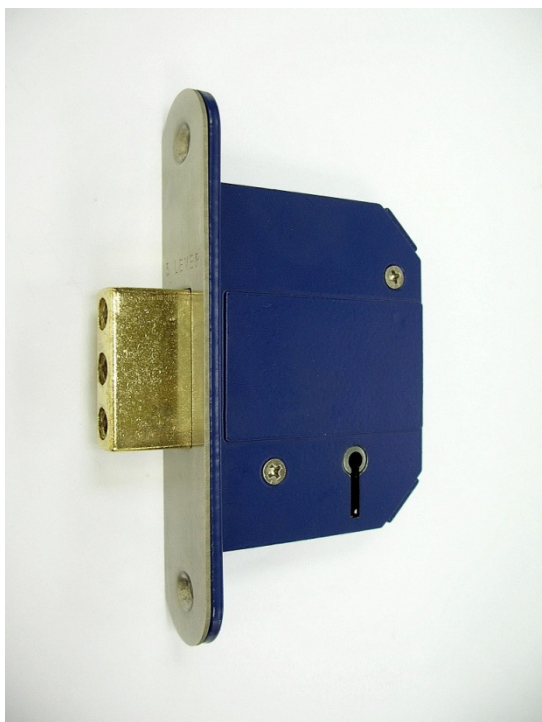

### DL3487 – 5 Levers Deadbolt Lock

- Brass deadbolt
- Brass forend & steel lock case
- 5 levers
- Lock case size 2-1/2"
- 3 brass keys

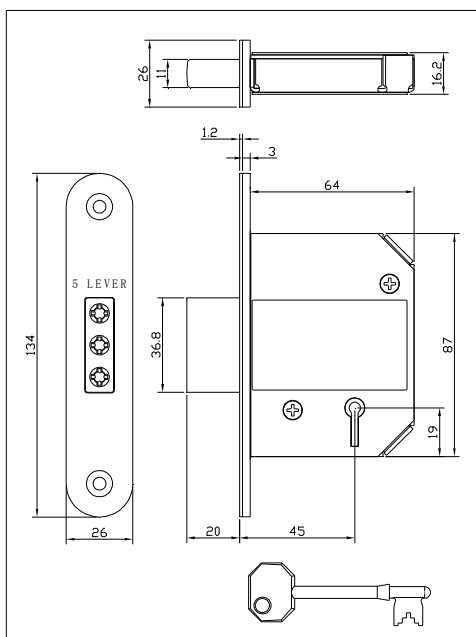

Backset 45mm

## Cylinder Mortise Lock



### DL3779 – Steel Mortise Lock

- Steel & Plastic deadbolt
- Steel forend & steel lock case
- Centre 54.7mm
- 1 zinc alloy key

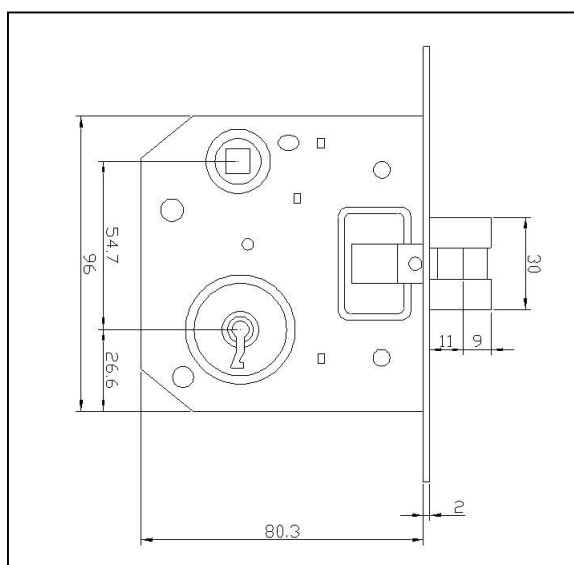

Backset 54.7mm

## Cylinder Mortise Lock



### DL2672 – 5 Levers Sash Lock

- Easy reversible latch for on site adjustment without opening lock case
- Brass latch & deadbolt
- Brass forend & steel lock case
- 5 levers
- Lock case size 2-1/2" or 3"
- 2 brass keys

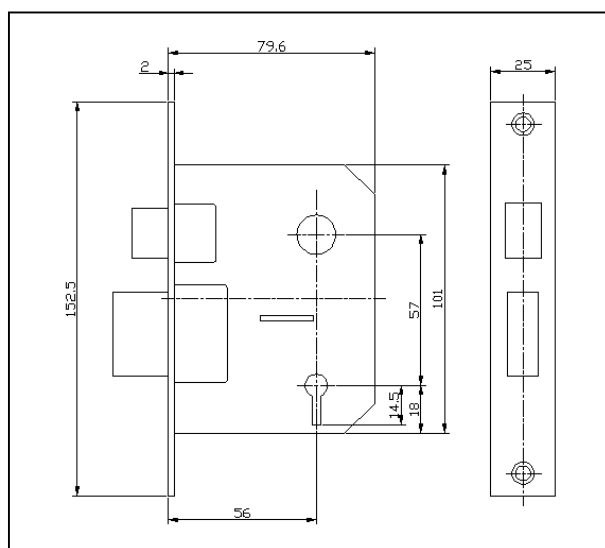

Backset 56 x c.c. 57 mm

## Cylinder Mortise Lock



### DL2762 – 5 Levers Deadbolt Lock

- Brass deadbolt
- Brass forend & steel lock case
- 5 levers
- Lock case size 2-1/2" or 3"
- Backset 56mm
- 2 brass keys

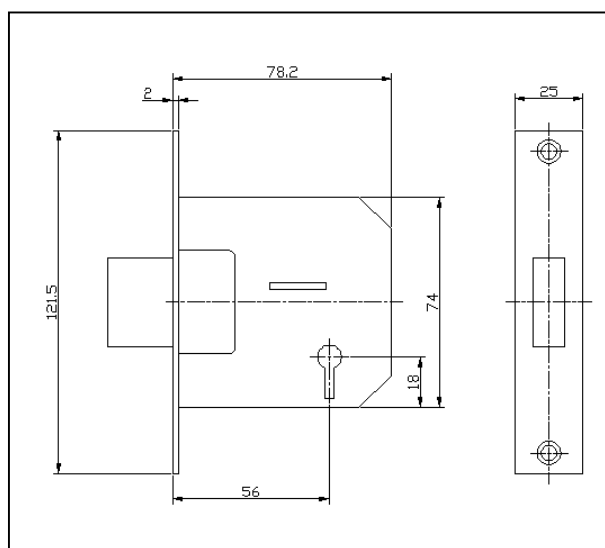

Backset 56mm



## Cylinder Mortise Lock

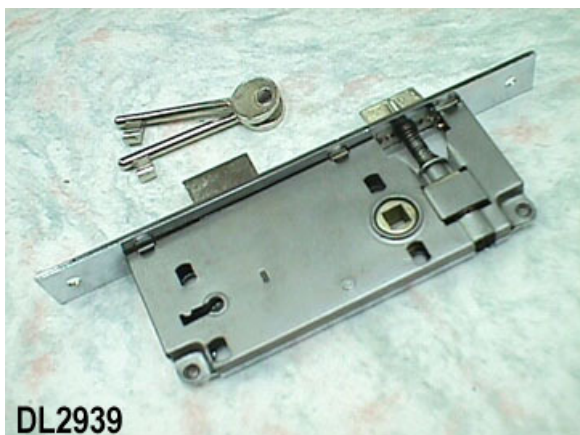

### DL2939 – Steel Mortise Lock

- Easy reversible latch for on site adjustment without opening lock case
- Zinc alloy latch, steel deadbolt and follower
- Steel forend and lock case
- Backset 40mm / 45mm
- Centre 75mm
- 2 zinc alloy keys
- Polished brass / Brass plated / Chrome plated forend are available

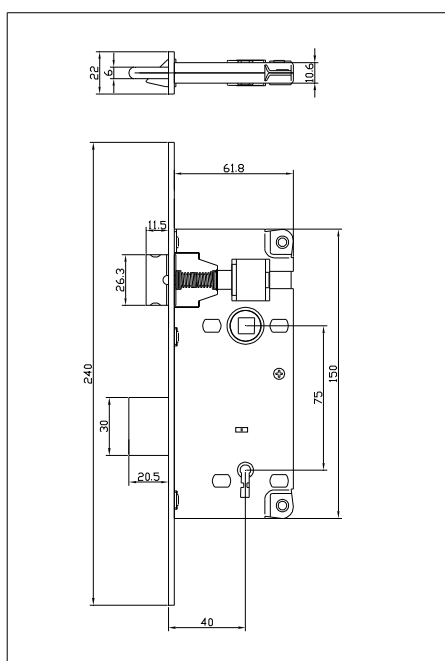

Backset 40 x c.c. 75 mm

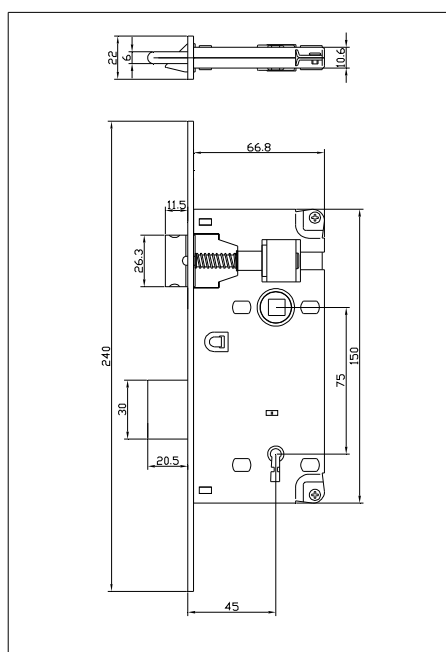

Backset 45 x c.c. 75 mm

## Cylinder Mortise Lock

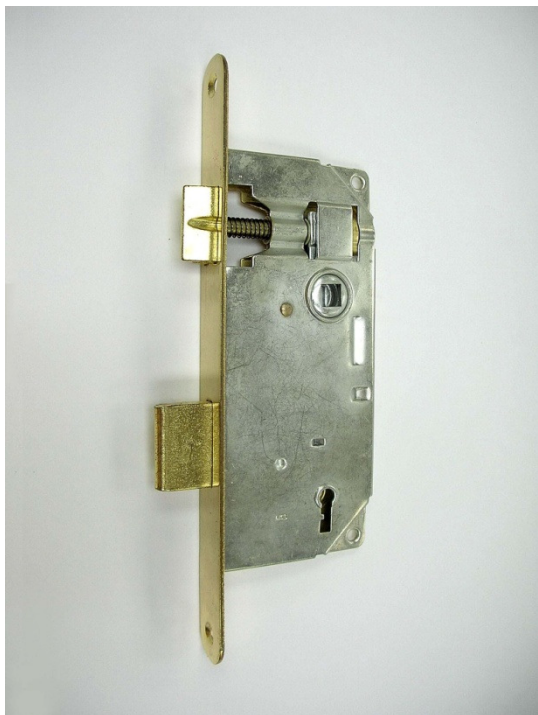

### DL3235 – Steel Mortise Lock

- Easy reversible latch for on site adjustment without opening lock case
- Zinc alloy latch, steel deadbolt and follower
- Steel forend and lock case
- Backset 44.5mm
- Centre 75mm
- 2 zinc alloy keys
- Electro brass plated and zinc plated lock case are available

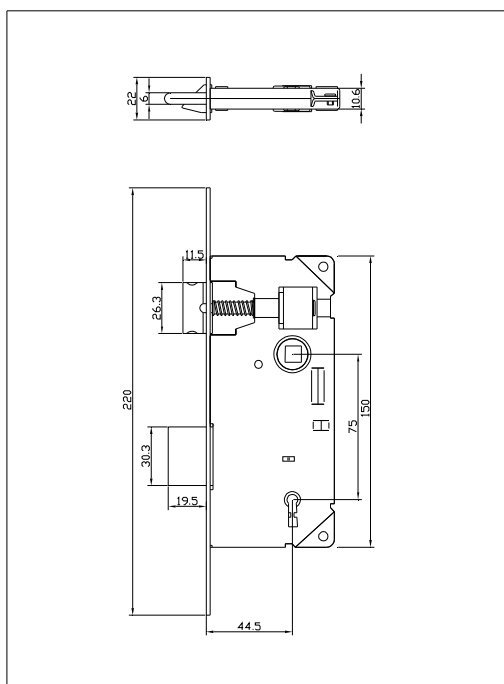

Backset 44.5 x c.c. 75 mm

## Cylinder Mortise Lock

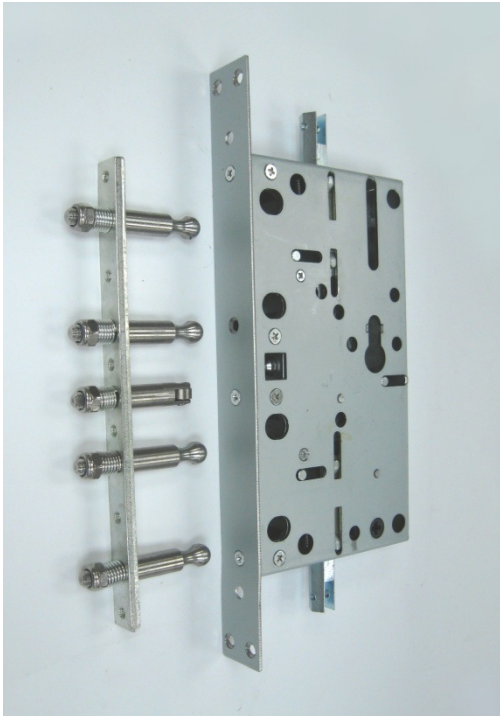

### DL3821 – Heavy Duty 3 Points Lock

- with 5 stainless steel bolts
- Stainless steel forend and steel lock case
- Backset 92mm
- Galvanized lock case

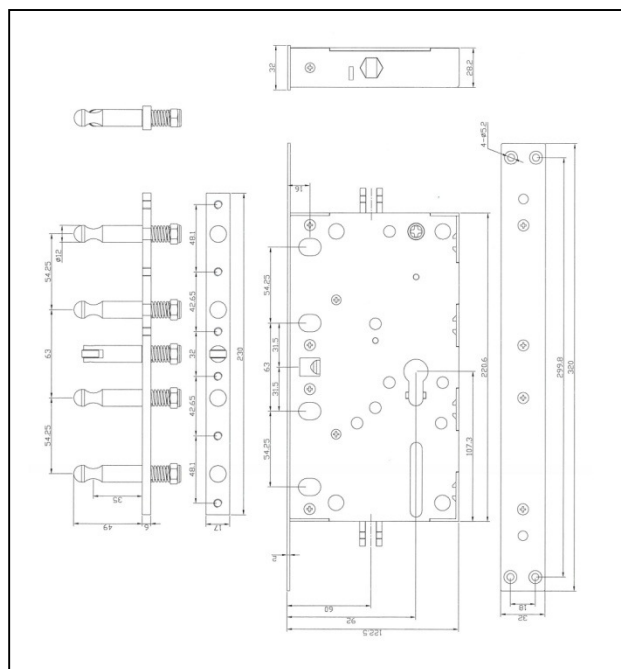

Backset 92mm

## Cylinder Mortise Lock



### DL3841 – Steel Mortise Lock

- Zinc alloy latch
- 4 cylindrical steel deadbolts
- Steel forend and lock case
- Backset 60mm
- Centre 80mm

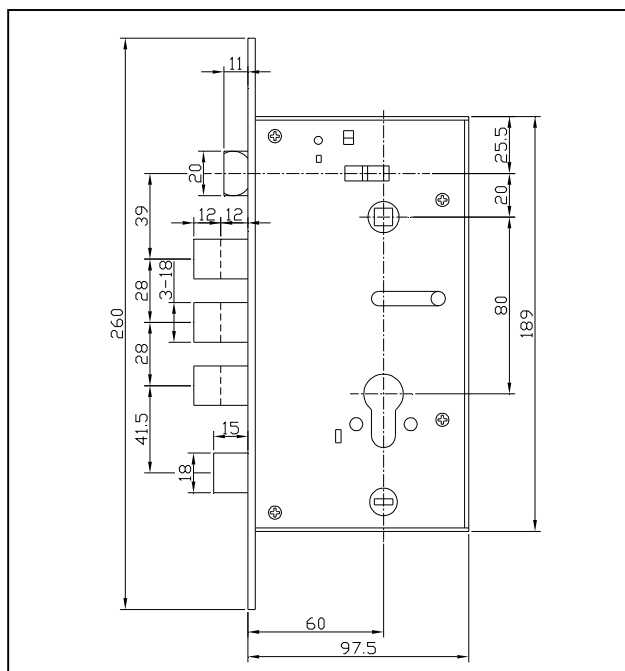

Backset 60 x c.c. 80 mm

## Cylinder Mortise Lock



### DL3842 – Steel Mortise Lock

- Zinc alloy latch
- 3 cylindrical steel deadbolts
- Steel forend and lock case
- with bearing handle shaft
- Backset 60mm
- Centre 85mm
- Brass plated / Chrome plated / Nickel plated forend are available

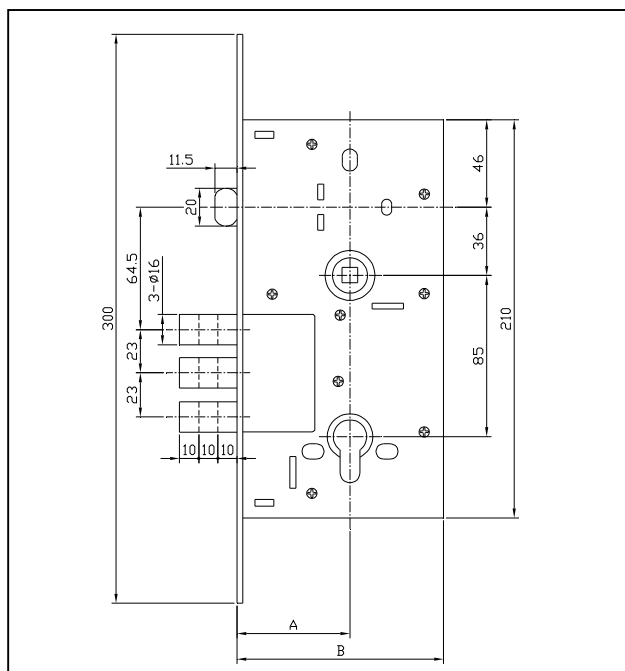

Backset 60 x c.c. 85 mm

## Cylinder Mortise Lock



### DL3843 – Steel Mortise Lock

- 3 cylindrical steel deadbolts
- Steel forend and lock case
- Backset 60mm
- Brass plated / Chrome plated / Nickel plated forend are available

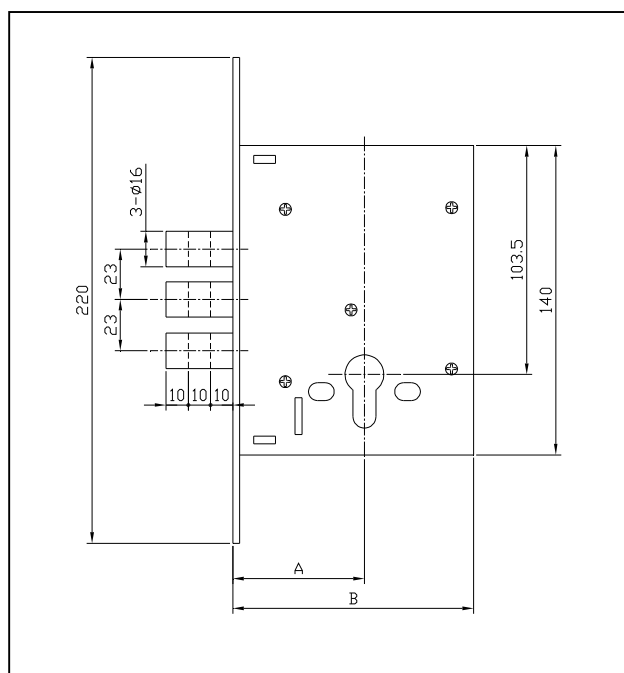

Backset 60 mm



## Cylinder Mortise Lock



### DL3844 – Steel Mortise Lock

- 4 cylindrical steel deadbolts
- Steel forend and lock case
- Backset 50mm
- Brass plated / Chrome plated / Nickel plated forend are available

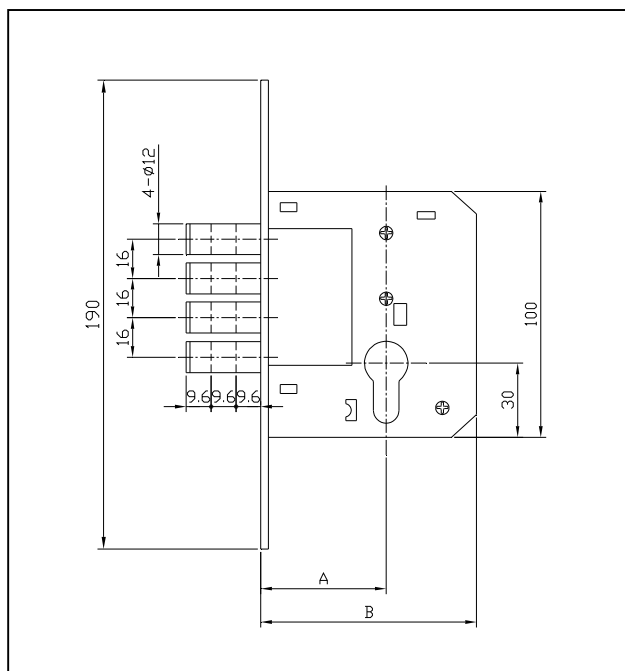

Backset 50 mm

## Cylinder Mortise Lock



### DL2309 – Steel Mortise Lock

- Brass latch
- 3 cylindrical steel deadbolts
- Steel forend & lock case
- Backset 45mm
- Centre 85mm
- Brass plated / Chrome plated / Nickel plated forend are available

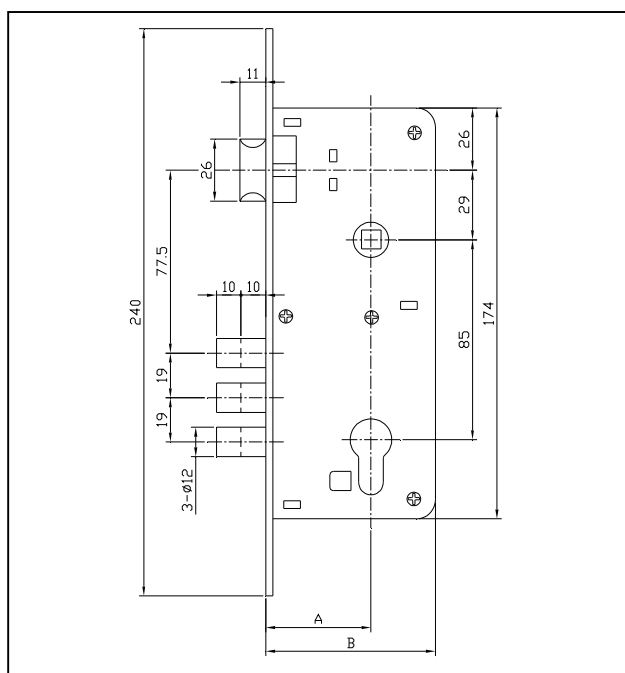

Backset 40 x c.c. 85 mm

## Cylinder Mortise Lock



### DL2346 – Steel Mortise Lock

- Brass latch & deadbolt
- Steel forend & lock case
- with bearing handle shaft
- Backset 35mm
- Centre 85mm
- Brass plated / Chrome plated / Nickel plated forend are available

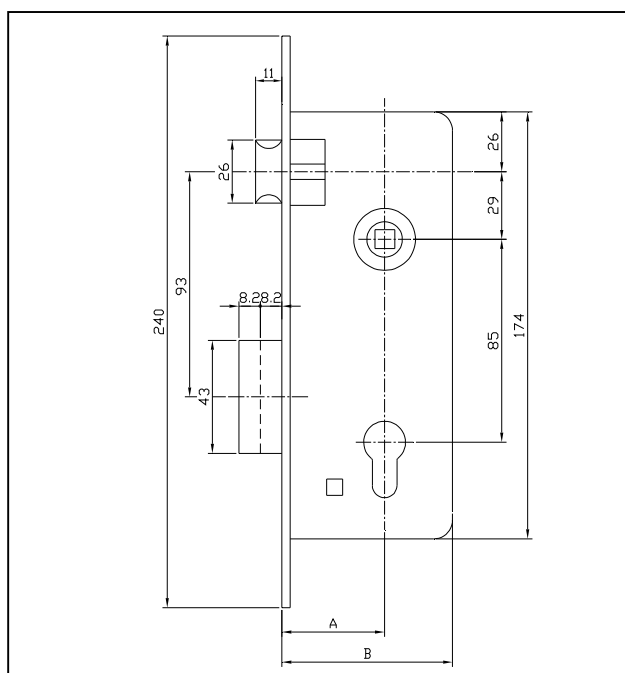

Backset 35 x c.c. 85 mm

## Cylinder Mortise Lock



### DL3836 – Steel Mortise Lock

- Brass latch
- Steel deadbolt, forend & lock case
- with bearing handle shaft
- Backset 45mm
- Centre 85mm
- Brass plated / Chrome plated / Nickel plated forend are available

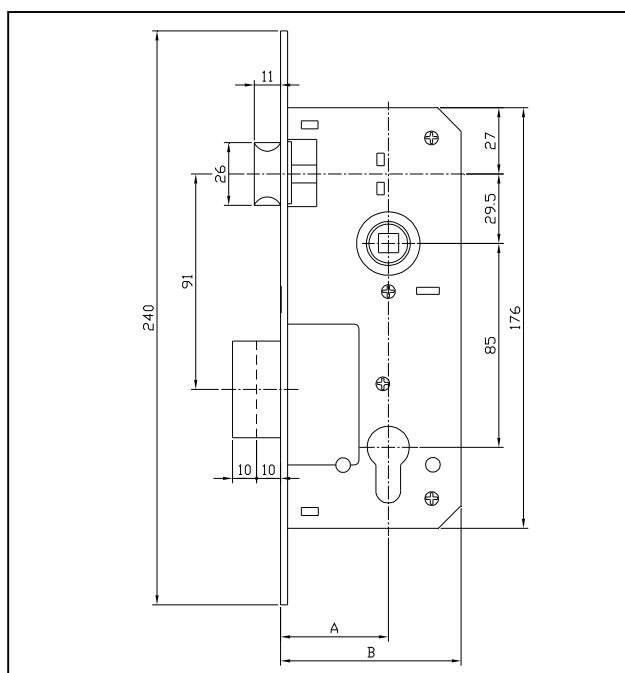

Backset 45 x c.c. 85 mm

## Cylinder Mortise Lock



### DL3837 – Steel Mortise Lock

- Brass latch & deadbolt
- Steel forend & lock case
- with bearing handle shaft
- Backset 45mm
- Centre 85mm
- Brass plated / Chrome plated / Nickel plated forend are available

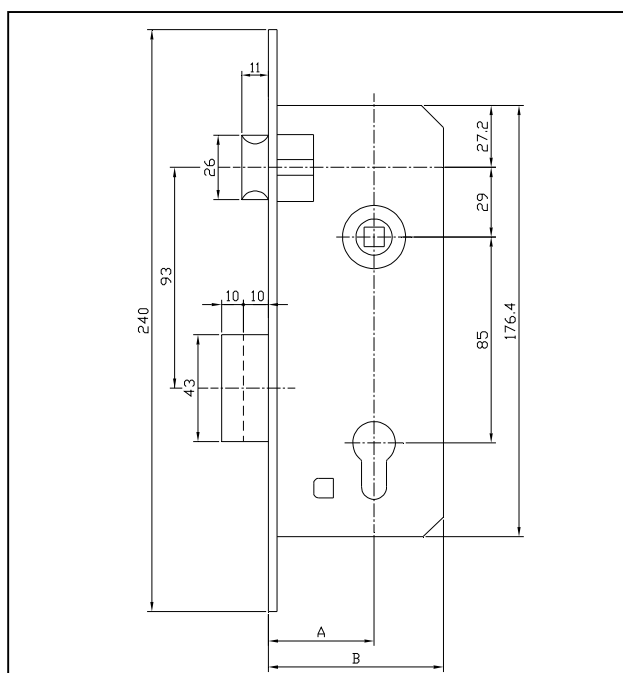

Backset 45 x c.c. 85 mm

## Cylinder Mortise Lock



## DL2480 – Steel Mortise Lock

- Brass latch & 3 square deadbolts
- Steel forend & lock case
- with bearing handle shaft
- Backset 45mm
- Centre 85mm
- Brass plated / Chrome plated / Nickel plated forend are available

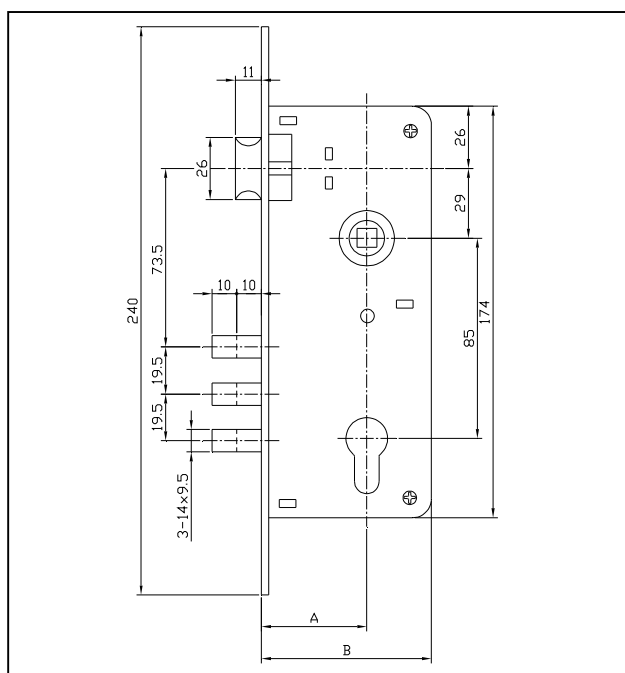

Backset 45 x c.c. 85 mm



## Cylinder Mortise Lock



### DL2827 – Steel Mortise Lock

- Brass latch
- 3 rotating steel cylindrical deadbolt
- Steel forend & lock case
- with bearing handle shaft
- Backset 45mm
- Centre 85mm
- Brass plated / Chrome plated / Nickel plated forend are available

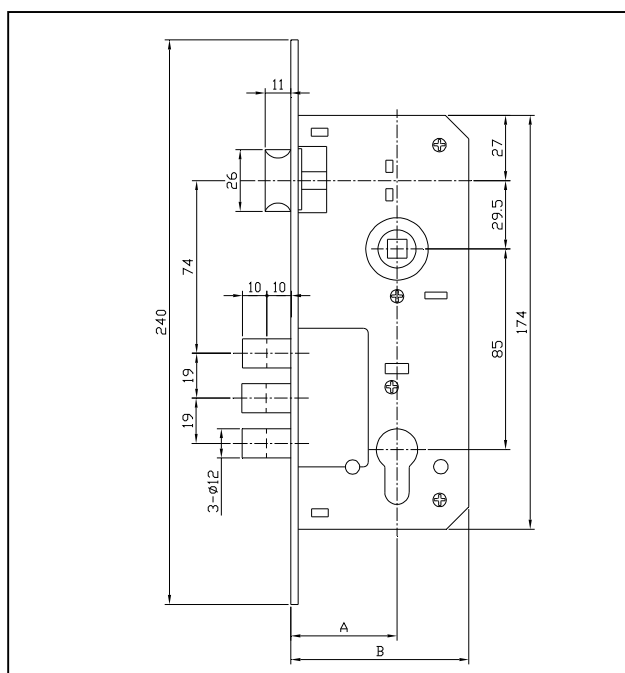

Backset 45 x c.c. 85 mm

## Cylinder Mortise Lock



## DL3838 – Steel Mortise Lock

- Brass latch & deadbolt
- Steel forend & lock case
- Backset 25mm
- Centre 85mm
- Brass plated / Chrome plated / Nickel plated forend are available

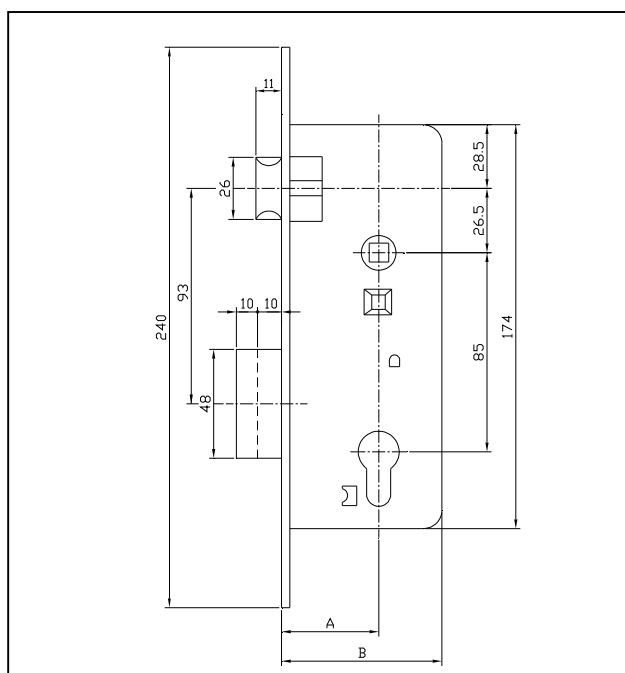

Backset 25 x c.c. 85 mm

## Cylinder Mortise Lock



### DL2534 – Steel Mortise Lock

- Brass latch & deadbolt
- Steel forend & lock case
- Backset 45mm
- Centre 85mm
- Brass plated / Chrome plated / Nickel plated forend are available

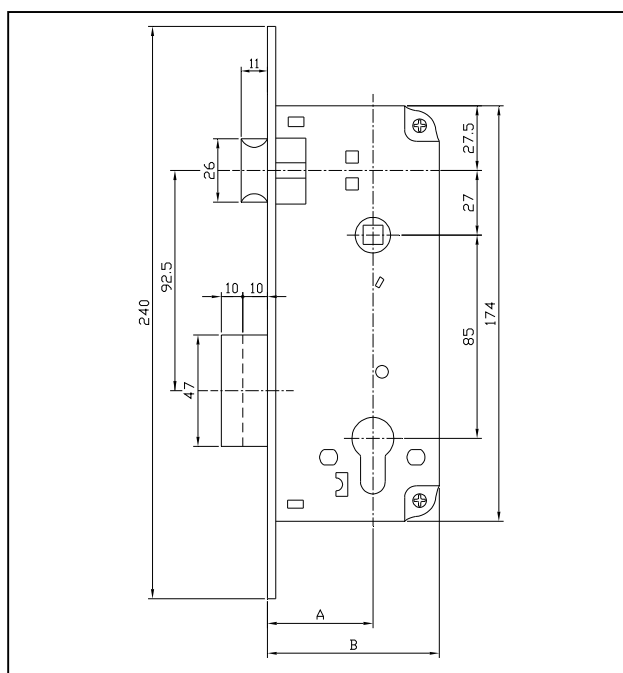

Backset 45 x c.c. 85 mm

## Cylinder Mortise Lock



### DL2826 – Steel Mortise Lock

- Brass latch
- Steel deadbolt, forend & lock case
- Backset 40mm
- Centre 85mm
- Brass plated / Chrome plated / Nickel plated forend are available

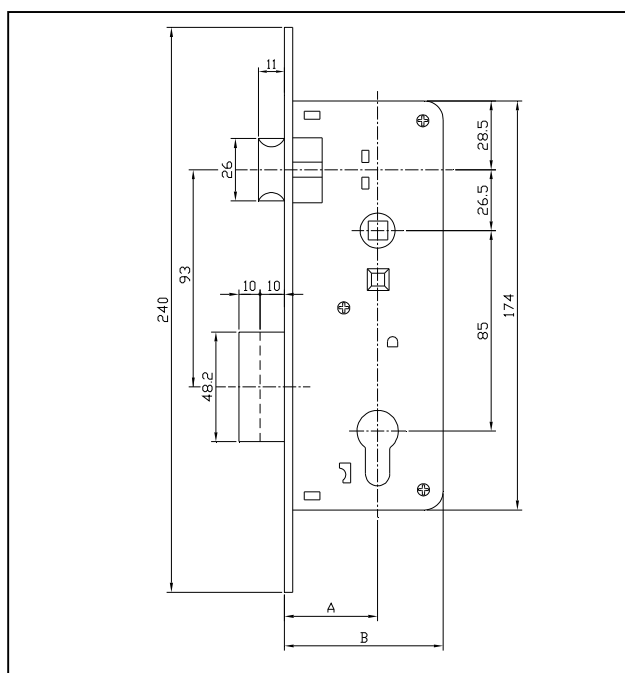

Backset 40 x c.c. 85 mm

## Cylinder Mortise Lock



### DL3845 – Steel Mortise Lock

- Zinc alloy latch & deadbolt
- Steel forend & lock case
- Backset 45mm
- Centre 85mm
- Brass plated / Chrome plated / Nickel plated forend are available

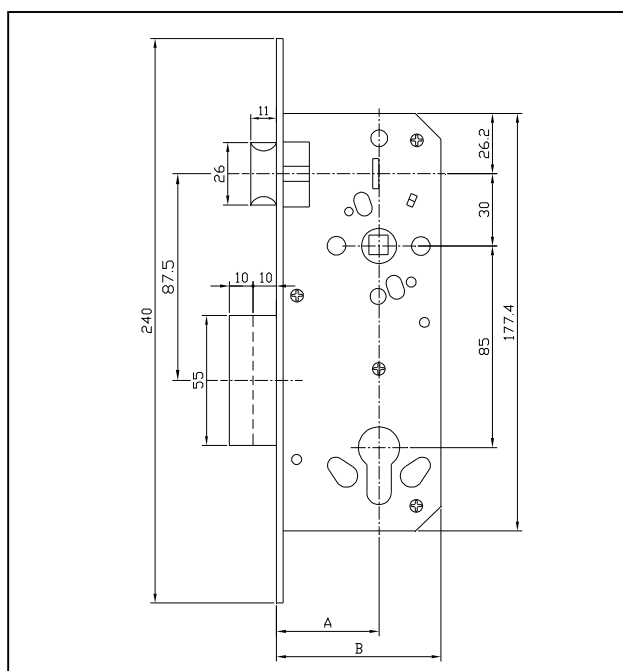

Backset 45 x c.c. 85 mm

## Cylinder Mortise Lock



### DL2893 – Steel Mortise Lock

- Brass latch
- Zinc alloy deadbolt
- Steel forend & lock case
- Backset 20mm / 25mm / 30mm / 35mm
- Centre 85mm
- Brass plated / Chrome plated / Nickel plated forend are available

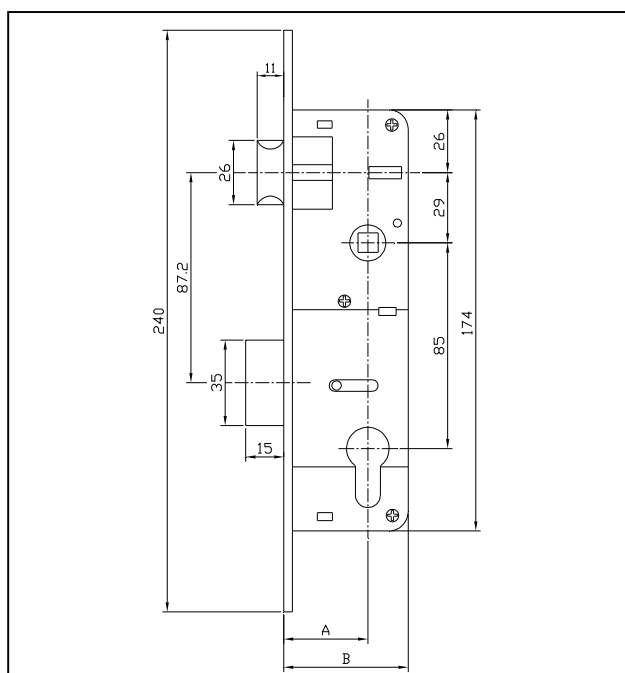

Backset 20mm / 25mm / 30mm / 35mm, Centre 85 mm

## Cylinder Mortise Lock



### DL2348 – Steel Mortise Lock

- Zinc alloy latch, brass deadbolt
- Steel forend and lock case
- Zinc alloy handle shaft
- Backset 40mm / 50mm / 60mm
- Centre 85mm
- Brass plated / Chrome plated / Nickel plated forend are available

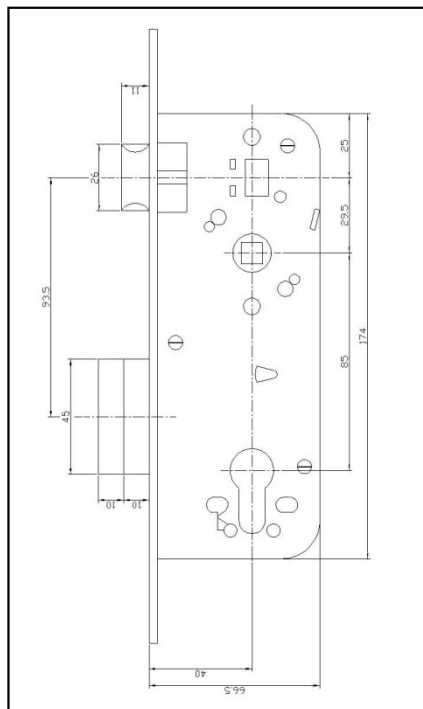

Backset 40 x c.c. 85 mm

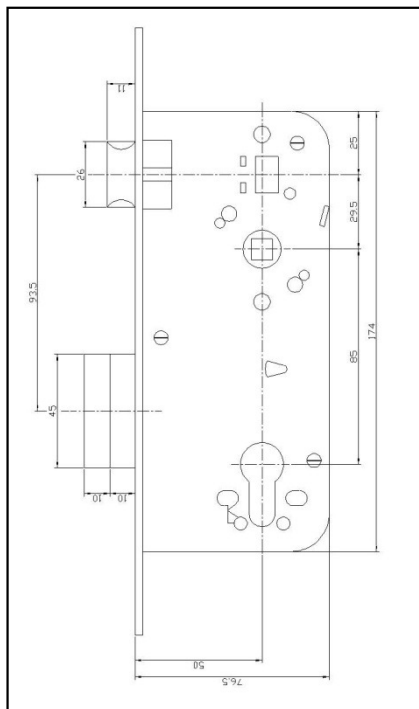

Backset 50 x c.c. 85 mm

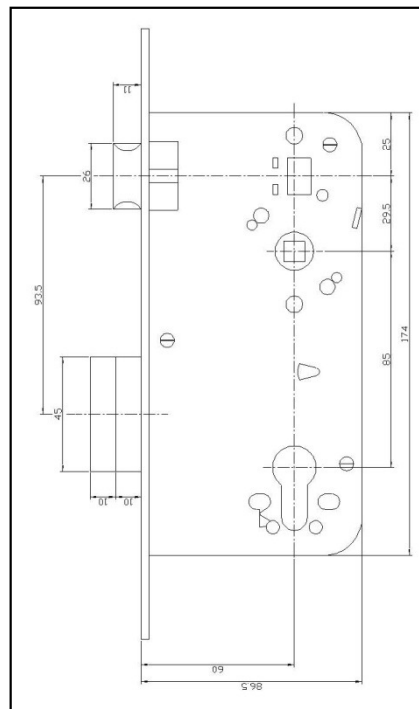

Backset 60 x c.c. 85 mm



## Cylinder Mortise Lock



### DL2031 – Steel Mortise Lock

- Steel latch
- Brass forend and steel lock case
- Backset 50mm
- Brass plated / Chrome plated / Nickel plated forend are available

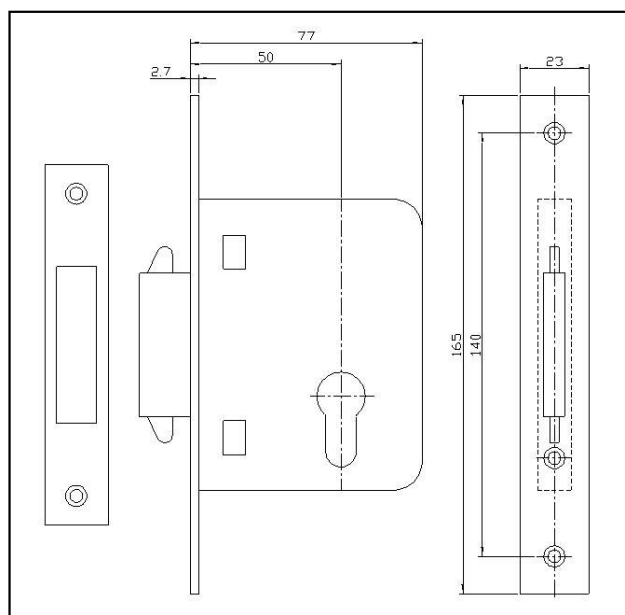

Backset 50 mm

## Cylinder Mortise Lock

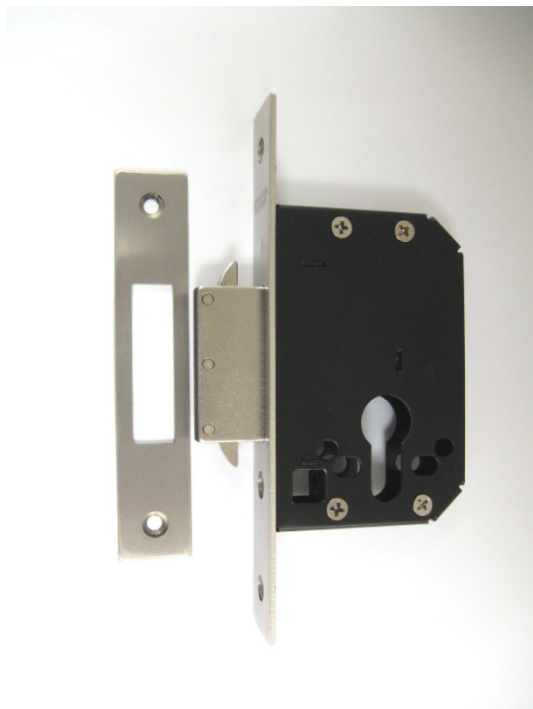

### DL3730 – Steel Mortise Lock

- Steel latch
- Steel forend and steel lock case
- Backset 40mm / 50mm / 60mm
- Brass plated / Chrome plated / Nickel plated forend are available

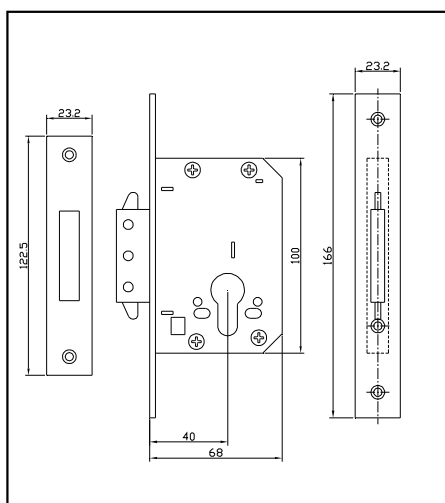

Backset 40 mm

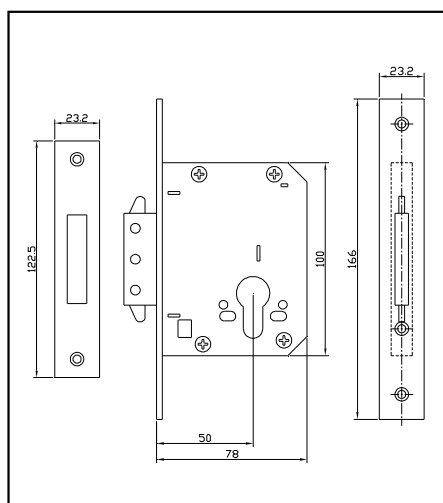

Backset 50 mm

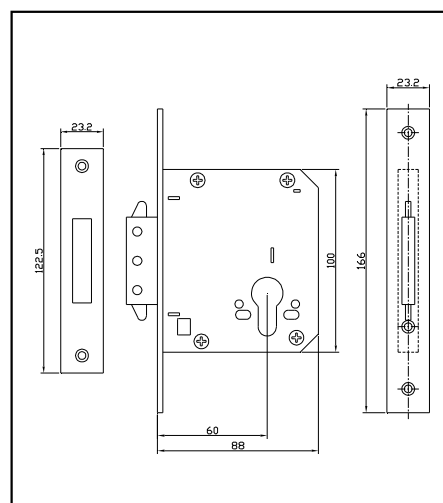

Backset 60 mm

## Cylinder Mortise Lock



### DL3839 – Steel Mortise Lock

- Zinc alloy hook bolt
- Steel forend and lock case
- with 5 cross keys
- Backset 20mm
- Brass plated / Chrome plated / Nickel plated forend are available

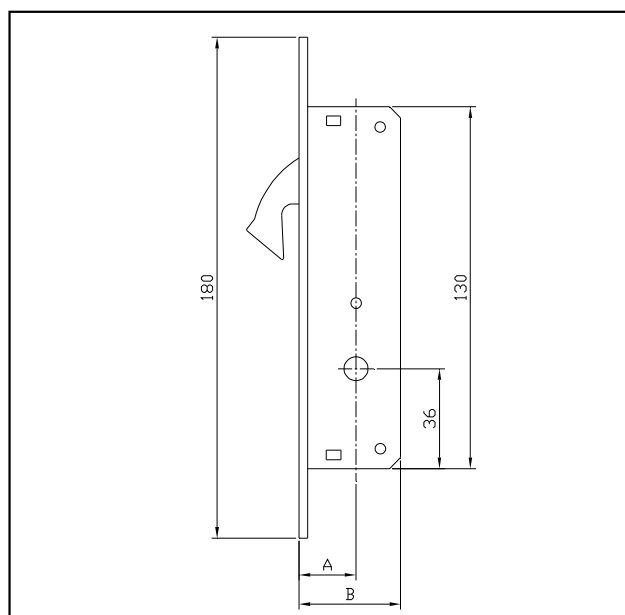

Backset 20mm

## Cylinder Mortise Lock



### DL3840 – Steel Mortise Lock

- Zinc alloy hook bolt
- Steel forend and lock case
- Backset 20mm
- Brass plated / Chrome plated / Nickel plated forend are available

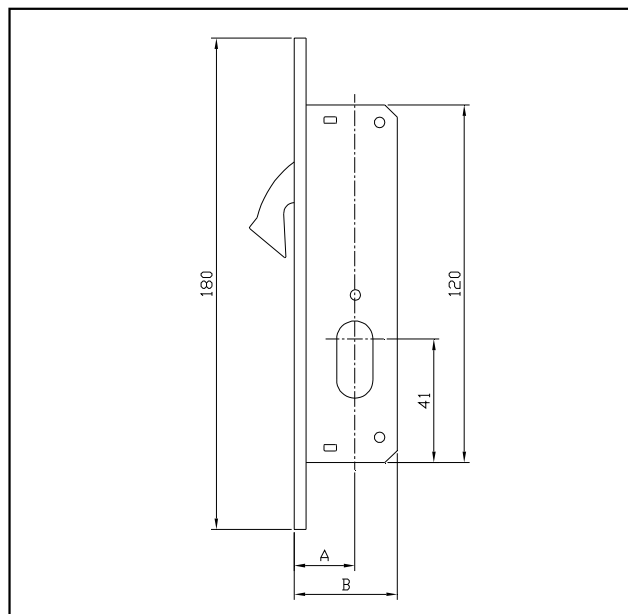

Backset 20mm

## Cylinder Mortise Lock



### DL3755 – Steel Mortise Lock

- Steel hook bolt
- Steel forend and lock case
- Backset 15 x 60mm(c.c)
- Brass plated / Chrome plated / Nickel plated forend are available

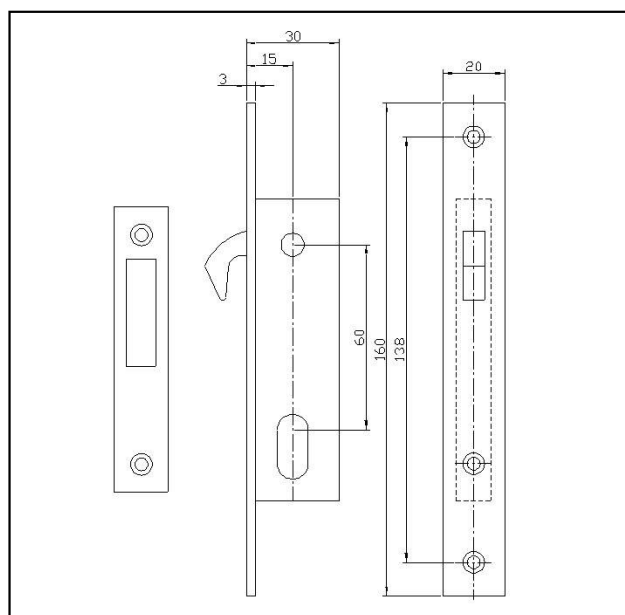

Backset 15 x c.c 60mm

## Cylinder Mortise Lock



### DL3683 – Steel Mortise Lock

- Brass hook bolt
- Steel forend and lock case
- Backset 50mm
- Brass plated / Chrome plated / Nickel plated forend are available

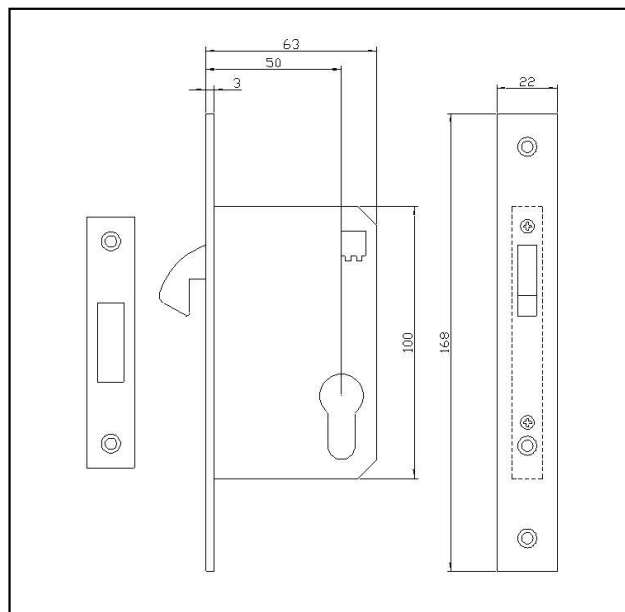

Backset 50mm

## Cylinder Mortise Lock



### DL3769 – Steel Mortise Lock

- Easy reversible latch bolt for on site adjustment without opening the lock case
- Brass latch and deadbolt
- Steel forend and steel lock case
- Lock case size 2-1/2" or 3"
- Backset 44mm
- Centre 47.5mm
- 2 brass keys
- Brass plated / Chrome plated / Nickel plated forend are available

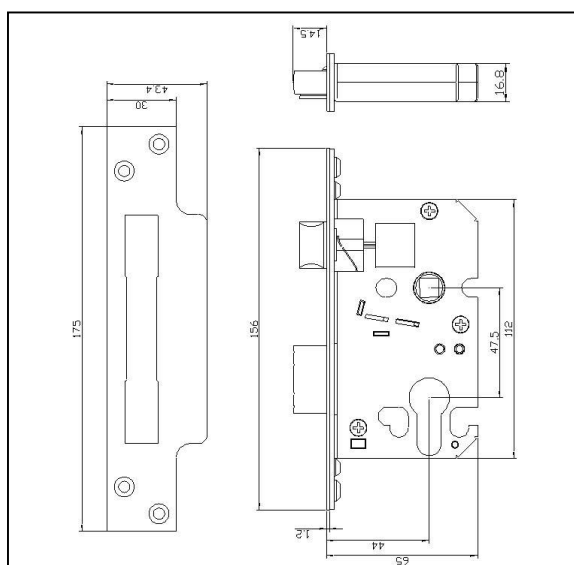

Backset 44.2 x c.c. 57 mm



## Cylinder Mortise Lock

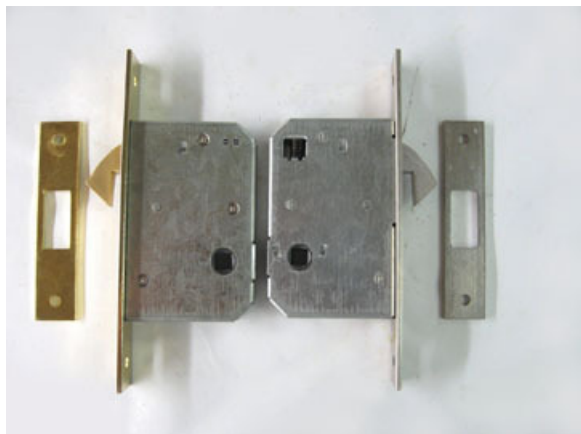

### DL3711 – Sliding Door Privacy Function Mortise Lock

- Brass hook bolt
- Brass / Stainless Steel forend
- Backset 50mm
- Brass plated / Chrome plated / Nickel plated forend are available

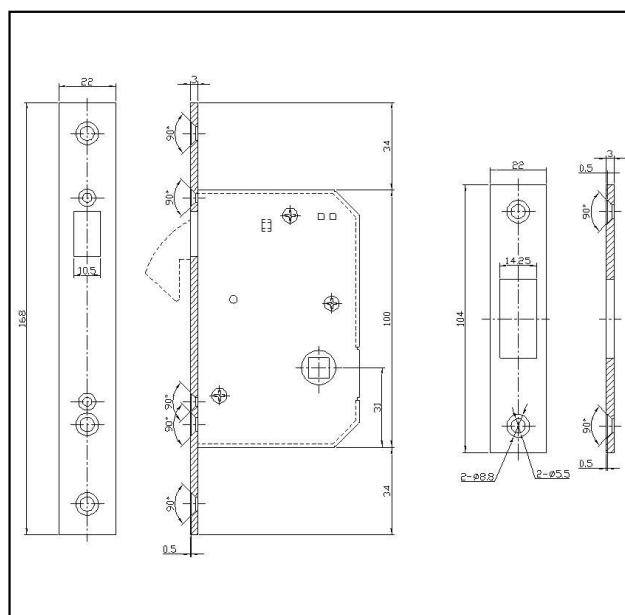

Backset 50mm

## Cylinder Mortise Lock



### DL3684 – Steel Mortise Lock

- Brass latch
- Steel forend and lock case
- Backset 25mm
- Brass plated / Chrome plated / Nickel plated forend are available

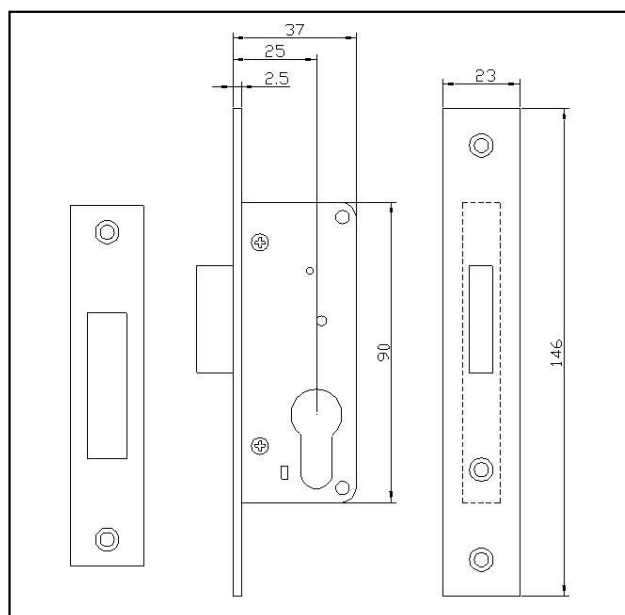

Backset 25mm

## Cylinder Mortise Lock

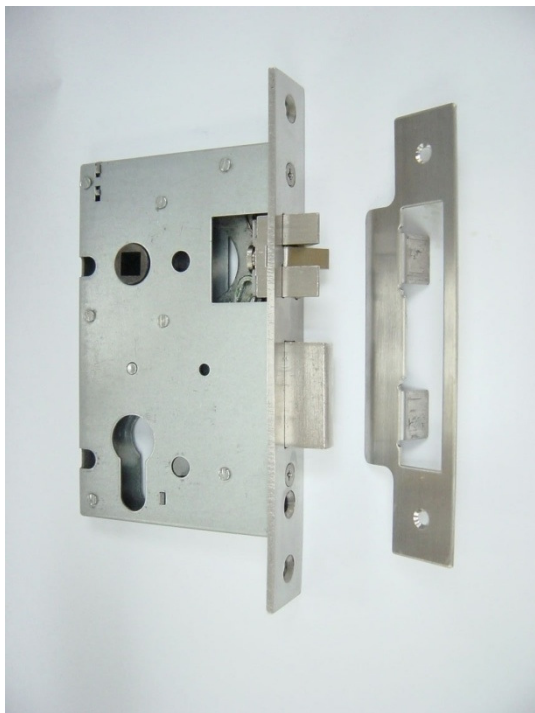

### DL3686 – Steel Mortise Lock

- Brass deadbolt & reversible latch
- Stainless steel forend and steel lockcase
- Backset 55 x c.c 60mm
- Brass plated / Chrome plated / Nickel plated forend are available

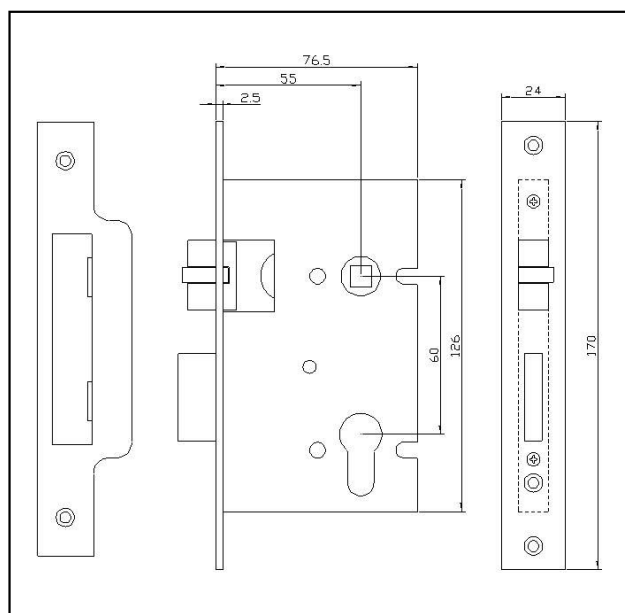

Backset 55 x c.c. 60mm

## Cylinder Mortise Lock



### DL3690 – Steel Mortise Lock

- Brass latch
- Steel forend and lock case
- Backset 15.5mm
- Brass plated / Chrome plated / Nickel plated forend are available

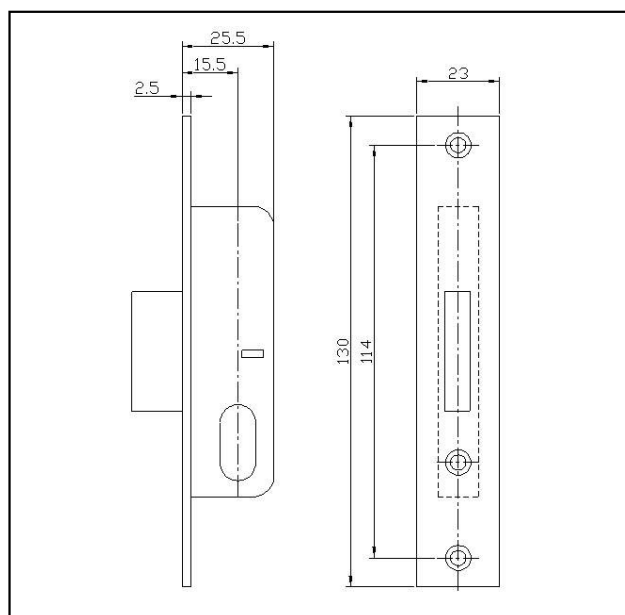

Backset 15.5mm

## Cylinder Mortise Lock

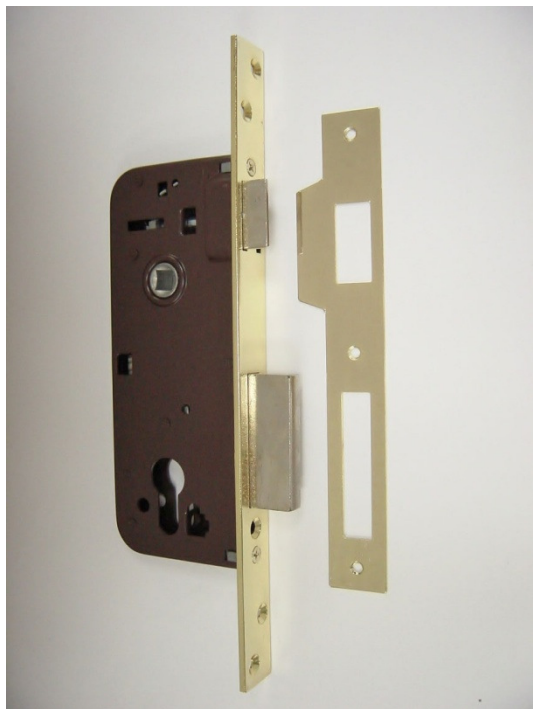

### DL3692 – Steel Mortise Lock

- Zinc alloy latch & deadbolt
- Steel forend and lock case
- Backset 40 x 85mm(c.c)
- Brass plated / Chrome plated / Nickel plated forend are available

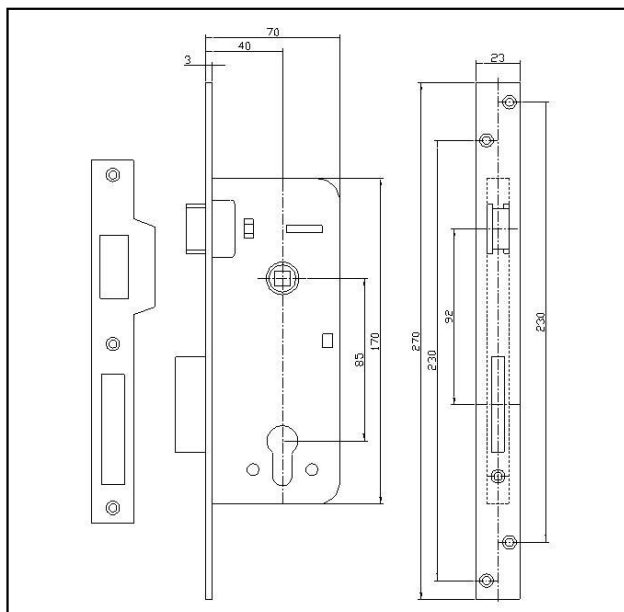

Backset 40 x c.c 85mm

## Cylinder Mortise Lock



### DL2027 – Steel Mortise Lock

- Brass latch & deadbolt
- Steel forend and lock case
- Backset 35 x 85mm(c.c) / Backset 60 x 85mm(c.c)
- Brass plated / Chrome plated / Nickel plated forend are available

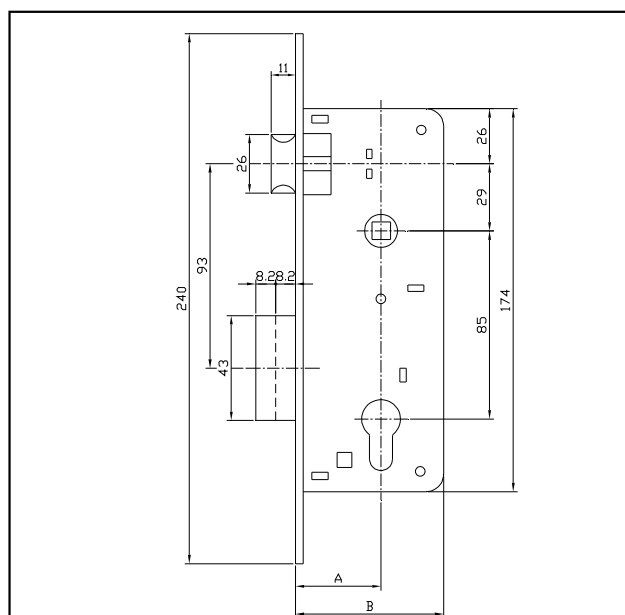

Backset 35 or 60 x c.c 85mm

## Cylinder Mortise Lock



### DL2935 – 2 Lever Mortise Lock

- Zinc alloy latch & deadbolt
- Steel forend and lock case
- Size: 2-1/2" or 3"
- Brass plated / Chrome plated / Nickel plated forend are available



## Cylinder Mortise Lock



### DL3693 – Steel Mortise Lock

- Zinc alloy deadbolt & reversible latch
- Stainless steel forend and steel lock case
- Backset 22 x 72mm(c.c)
- Brass plated / Chrome plated / Nickel plated forend are available

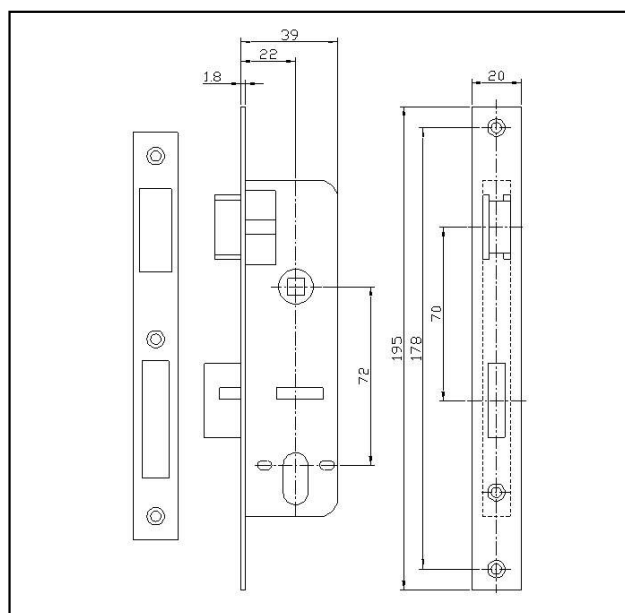

Backset 22 x c.c 72mm

## Cylinder Mortise Lock

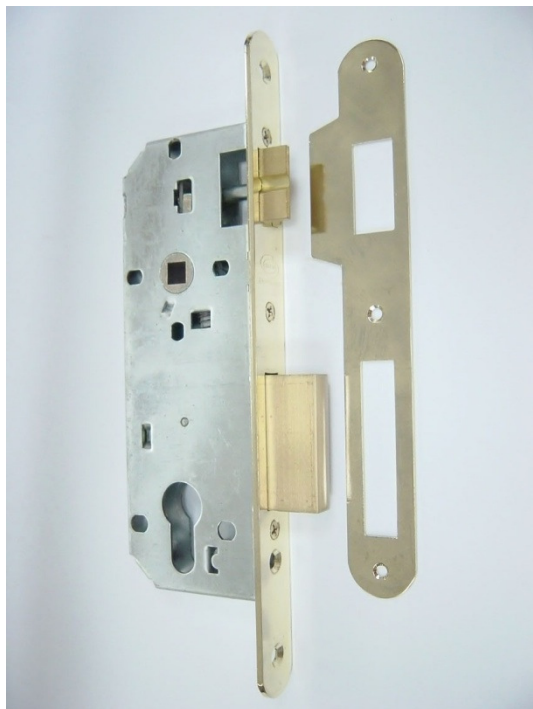

### DL3694 – Steel Mortise Lock

- Brass deadbolt & reversible latch
- Steel forend and lock case
- Backset 35 x 85mm(c.c)
- Brass plated / Chrome plated / Nickel plated forend are available

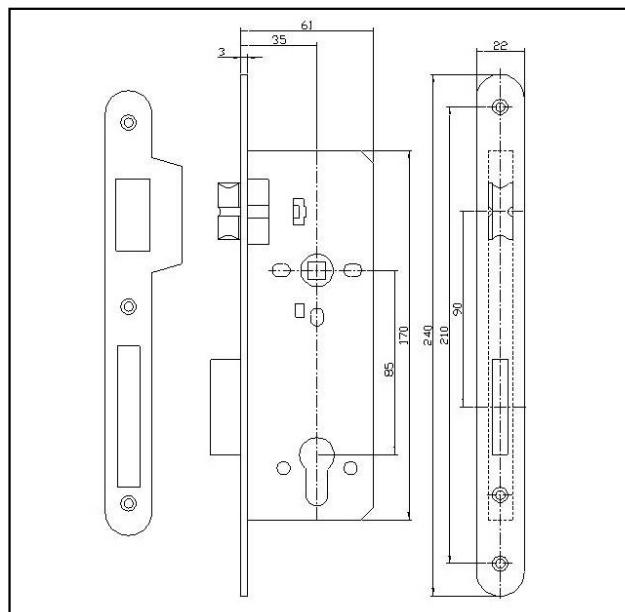

Backset 35 x c.c 85mm

## Cylinder Mortise Lock



### DL3814 – Steel Mortise Lock

- Zinc alloy latch & deadbolt
- Steel forend and lock case
- Backset 25mm / 30mm / 35mm
- Centre 85mm
- Brass plated / Chrome plated / Nickel plated forend are available

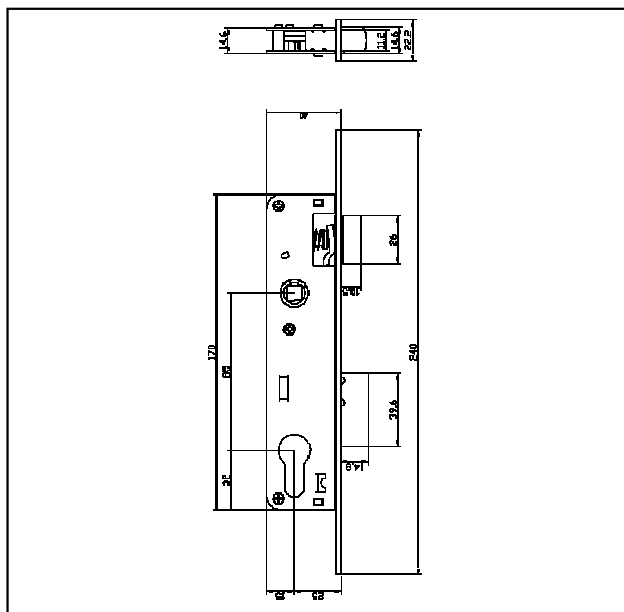

Backset 25 x c.c 85mm

## Cylinder Mortise Lock



### DL3695 – Steel Mortise Lock

- Brass deadbolt
- Steel forend and lock case
- Backset 40mm
- Brass plated / Chrome plated / Nickel plated forend are available

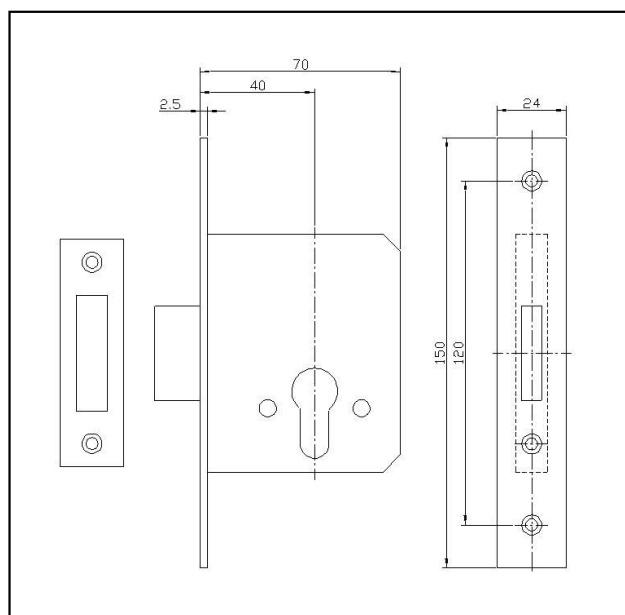

Backset 40mm

## Cylinder Mortise Lock

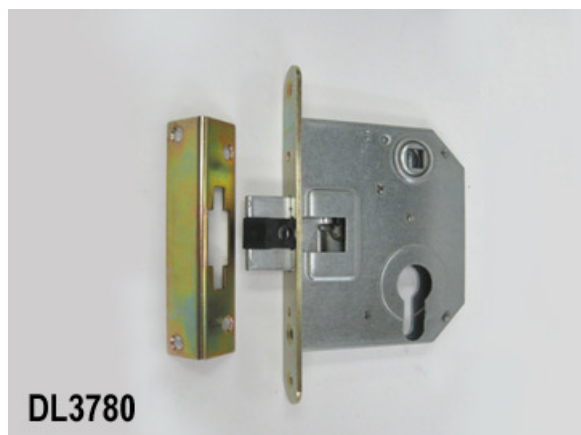

### DL3780 – Steel Mortise Lock

- Steel & Plastic deadbolt
- Steel forend and lock case
- Centre 54.7mm

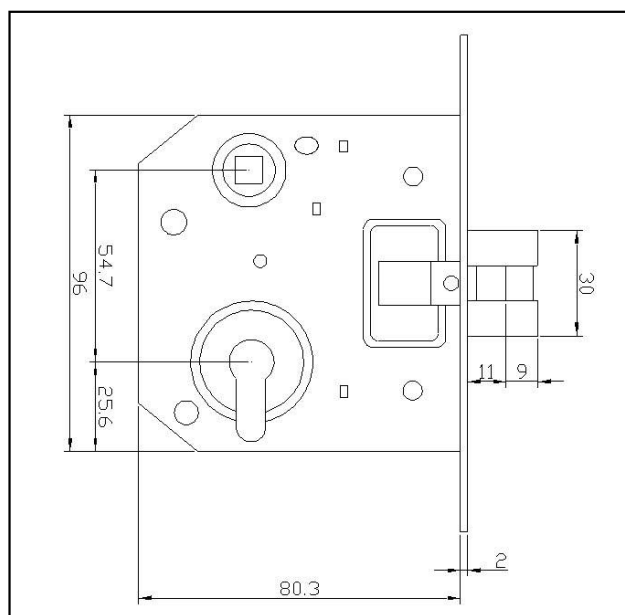

Centre 54.7mm

## Cylinder Mortise Lock

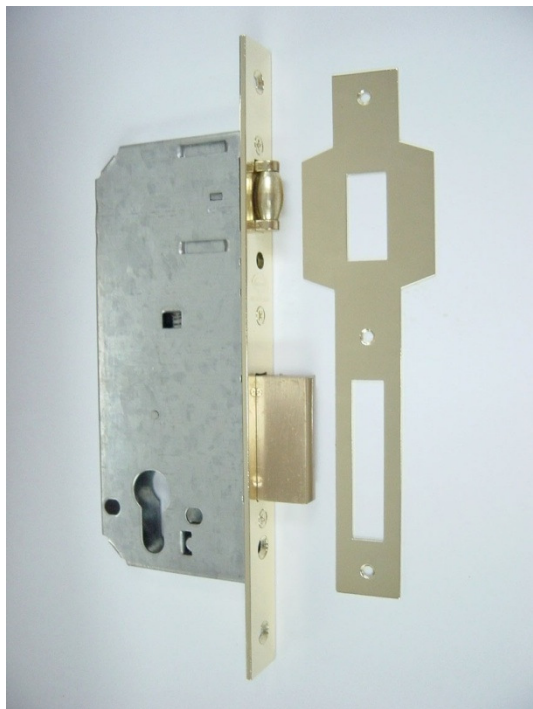

### DL3696 – Steel Mortise Lock

- Steel roller latch & brass deadbolt
- Steel forend and lock case
- Backset 45mm
- Brass plated / Chrome plated / Nickel plated forend are available

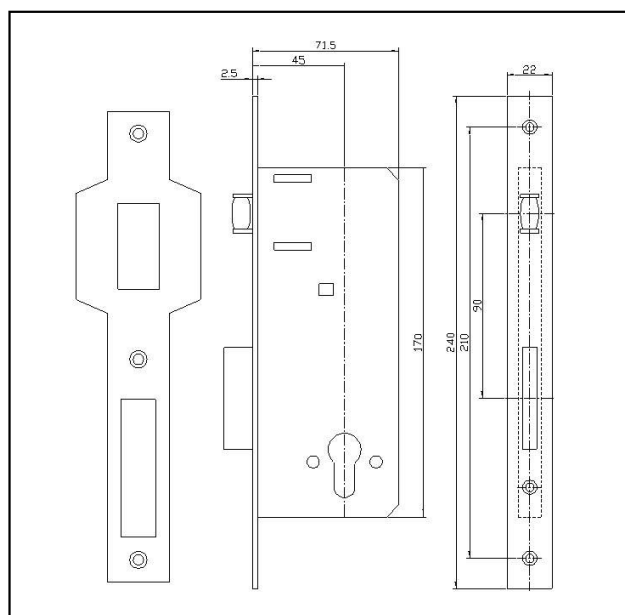

Backset 45mm

## Cylinder Mortise Lock



### DL3822 – Steel Mortise Lock

- Zinc alloy latch & deadbolt
- Steel forend and lock case
- Backset 25mm / 30mm / 35mm / 40mm / 45mm
- Chrome plated / Nickel plated forend are available

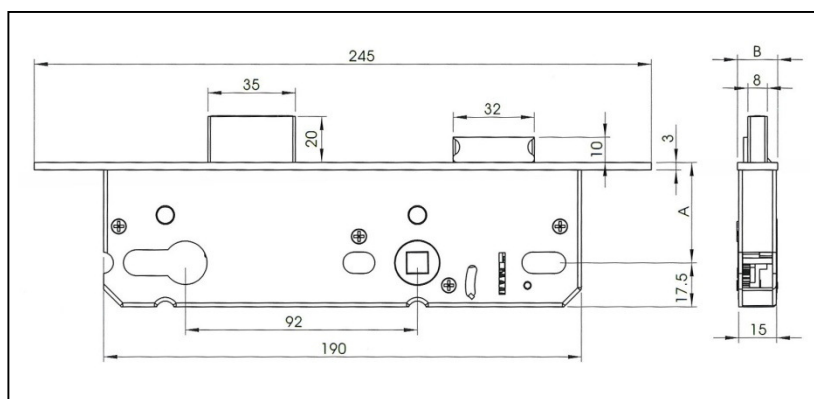

Backset 25mm / 30mm / 35mm / 40mm / 45mm



## Cylinder Mortise Lock



### DL3823 – Steel Mortise Lock

- Zinc alloy deadbolt
- Steel forend and lock case
- Backset 25mm / 30mm / 35mm / 40mm / 45mm
- Chrome plated / Nickel plated forend are available

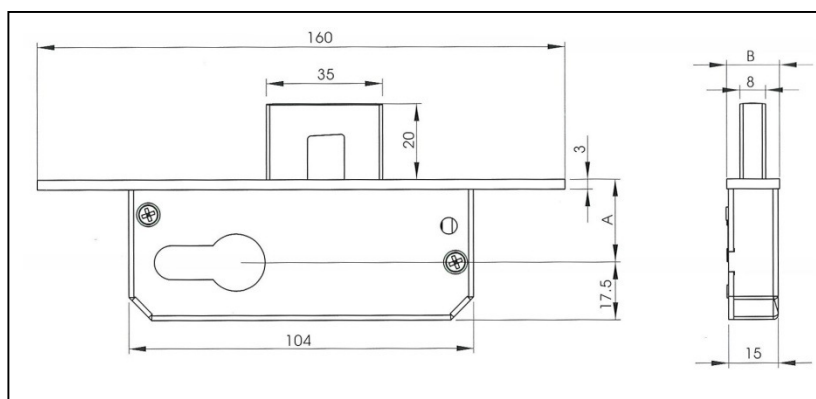

Backset 25mm / 30mm / 35mm / 40mm / 45mm

## Cylinder Mortise Lock



### DL3824 – Steel Mortise Lock

- Zinc alloy deadbolt & steel roller latch
- Steel forend and lock case
- Backset 25mm / 30mm / 35mm / 40mm / 45mm
- Chrome plated / Nickel plated forend are available

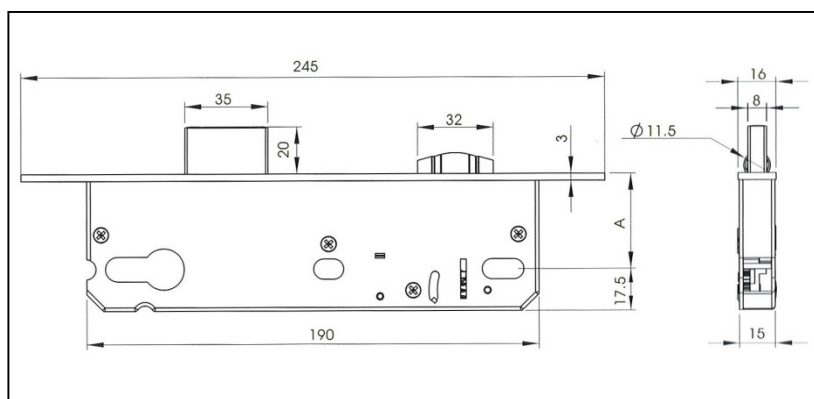

Backset 25mm / 30mm / 35mm / 40mm / 45mm

## Cylinder Mortise Lock



### DL2029 – Steel Mortise Lock

- Zinc alloy deadbolt & brass roller latch
- Steel forend and lock case
- Backset 30mm / 35mm
- Chrome plated / Nickel plated forend are available

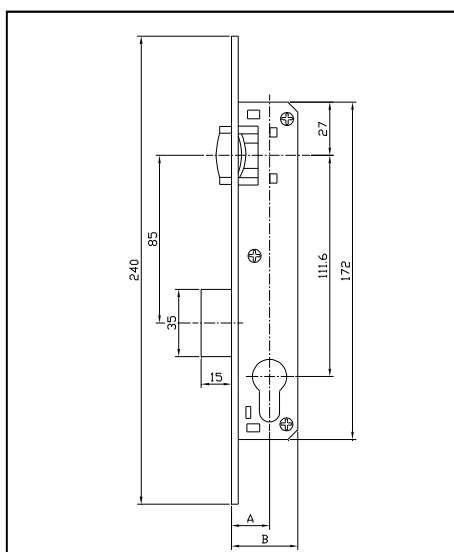

Backset 30mm / 35mm

## Cylinder Mortise Lock

**DL2307**

### DL2307 – Steel Mortise Lock

- Zinc alloy deadbolt & latch
- Steel forend and lock case
- Centre 85mm
- Backset 20mm / 25mm / 30mm / 35mm
- Chrome plated / Nickel plated forend are available

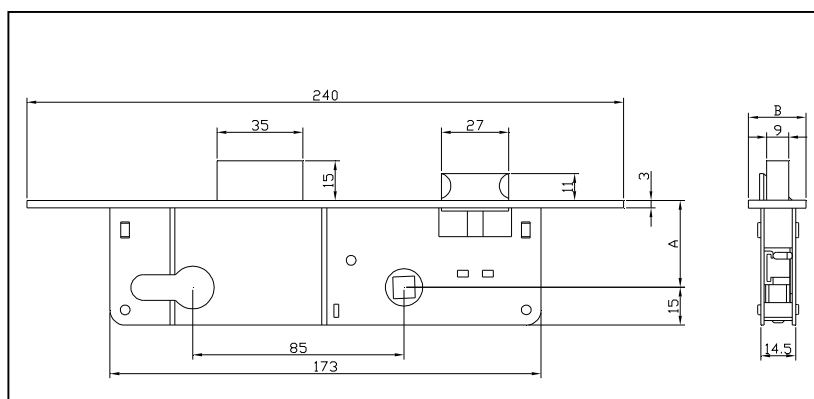
**Centre 85mm, Backset 20mm / 25mm / 30mm / 35mm**

## Cylinder Mortise Lock

**DL2491**

### DL2491 – Steel Mortise Lock

- Zinc alloy deadbolt & latch
- Steel forend and lock case
- Centre 85mm
- Backset 25mm / 30mm / 35mm
- Chrome plated / Nickel plated forend are available

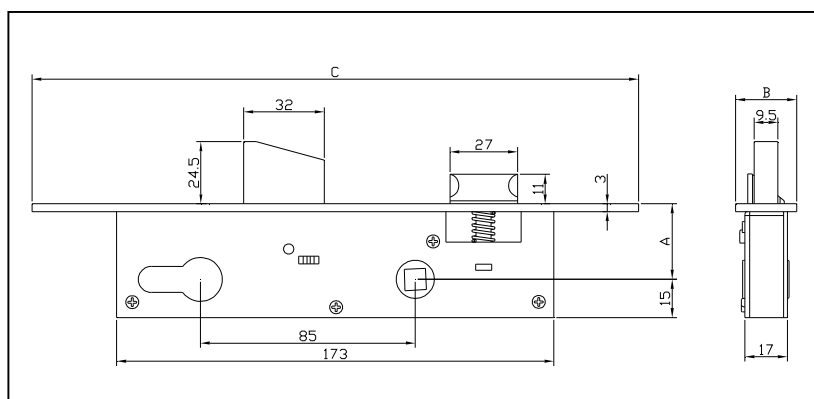

Centre 85mm, Backset 25mm / 30mm / 35mm

## Cylinder Mortise Lock

**DL2536**

### DL2536 – Steel Mortise Lock

- Zinc alloy deadbolt & latch
- Steel forend and lock case
- Centre 85mm
- Backset 20mm / 25mm / 30mm / 35mm
- Chrome plated / Nickel plated forend are available

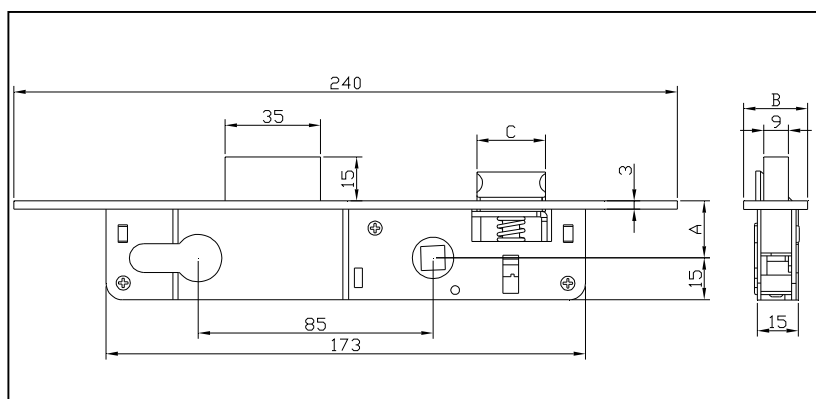
**Centre 85mm, Backset 20mm / 25mm / 30mm / 35mm**

## Cylinder Mortise Lock

**DL2328**

### DL2328 – Steel Mortise Lock

- Steel hook bolt
- Steel forend and lock case
- Backset 22mm
- Chrome plated / Nickel plated forend are available

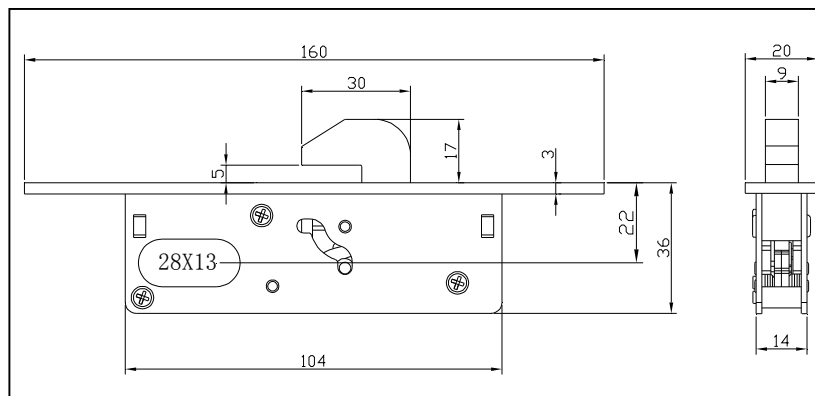

Backset 22mm

## Cylinder Mortise Lock



### DL2499 – Steel Mortise Lock

- Brass latch
- Steel forend
- Galvanized whole lock
- Backset 80mm
- Center 67mm
- Lock case: 175 x 45 x 13mm
- Chrome plated / Nickel plated forend are available

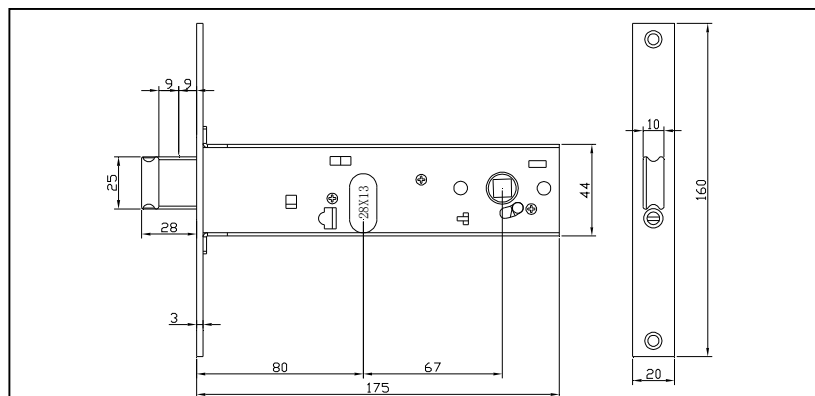

Backset 80 x c.c 67mm



## Cylinder Mortise Lock

**DL2142**

### DL2142 – Steel Mortise Lock

- Zinc alloy deadbolt
- Steel / stainless steel forend
- Backset 20mm
- Chrome plated / Nickel plated forend are available

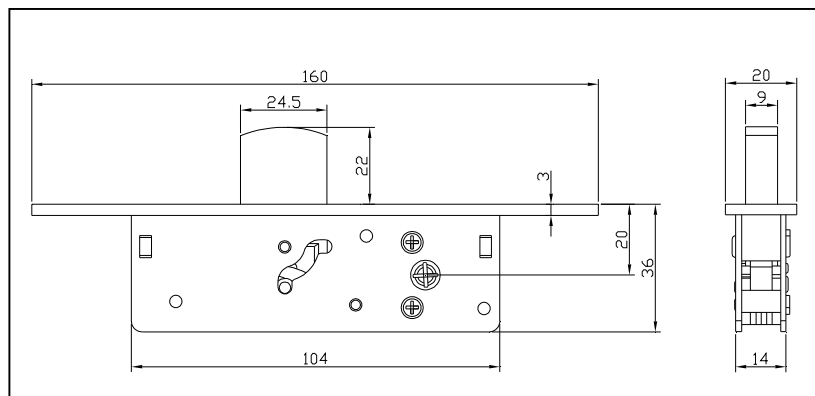
**Backset 20mm**

## Cylinder Mortise Lock

### DL2143 – Steel Mortise Lock

- Zinc alloy hook bolt
- Stainless steel forend & steel lock case
- with brass cross keys
- Backset 20mm
- Chrome plated / Nickel plated forend are available



**DL2143**

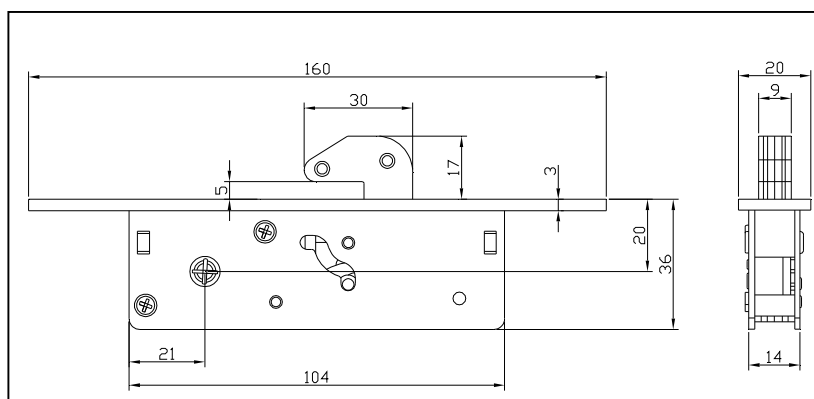

Backset 20mm

## Cylinder Mortise Lock



### DL3860 – Steel 4 Lever Mortise Lock

- Steel hook bolt
- Steel forend & lock case
- with 2 zinc alloy keys
- Backset 20mm
- Chrome plated / Nickel plated forend are available

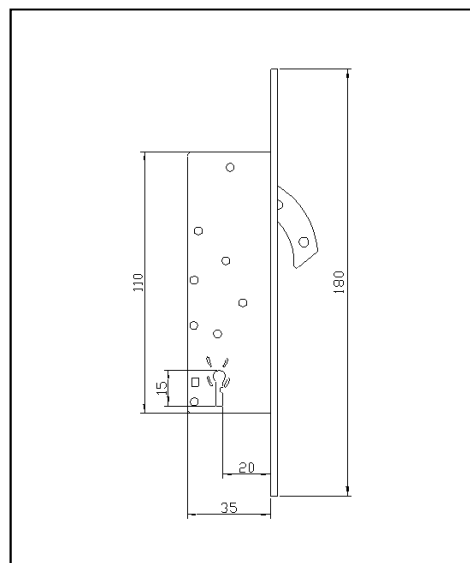

Backset 20mm

## Cylinder Mortise Lock



### DL3698 – Steel Mortise Lock

- Brass deadbolt & reversible latch
- Stainless steel forend and steel lock case
- Backset 60 x 68mm(c.c)
- Brass plated / Chrome plated / Nickel plated forend are available

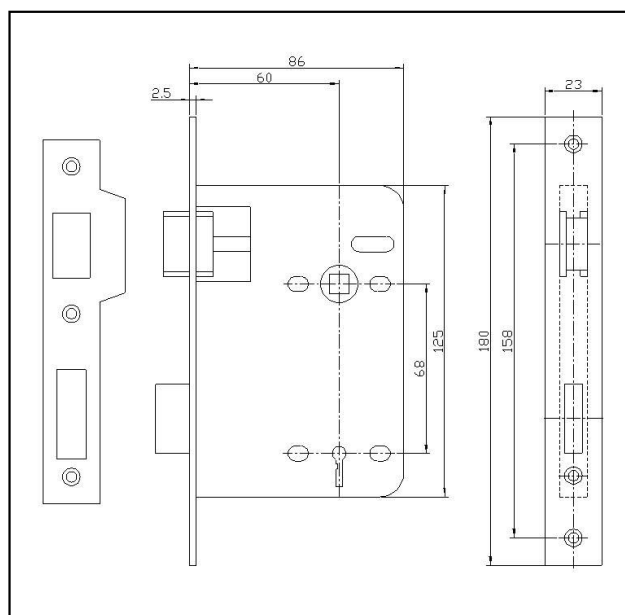

Backset 60 x c.c 68mm

## Cylinder Mortise Lock



### DL2844 – Steel Mortise Lock

- Steel pin & hook
- Steel forend and steel yellow zinc plated lock case
- Backset 50mm / 60mm / 65mm
- Centre 72mm

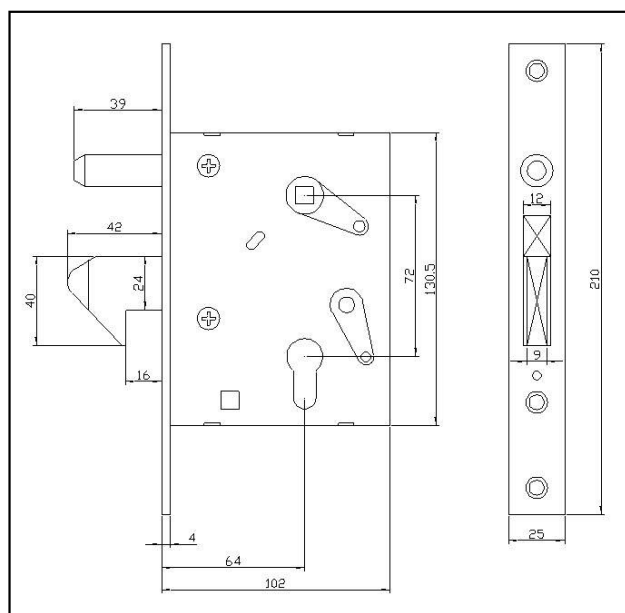

Backset 64 x c.c 72mm

## Cylinder Mortise Lock



**DL2869**

### DL2869 – Heavy Duty Mortise Lock

- Brass deadbolt & latch
- Stainless steel#304 forend and Stainless steel#430 lock case
- Backset 64 x 87mm
- with Brass cylinder size: 35mm / 38mm

## Cylinder Mortise Lock



### DL2490 – Steel Built-in Mortise Lock

- 2 cylindrical deadbolts
- 3 cross keys
- Backset 45mm
- Zinc plated / Chrome plated are available

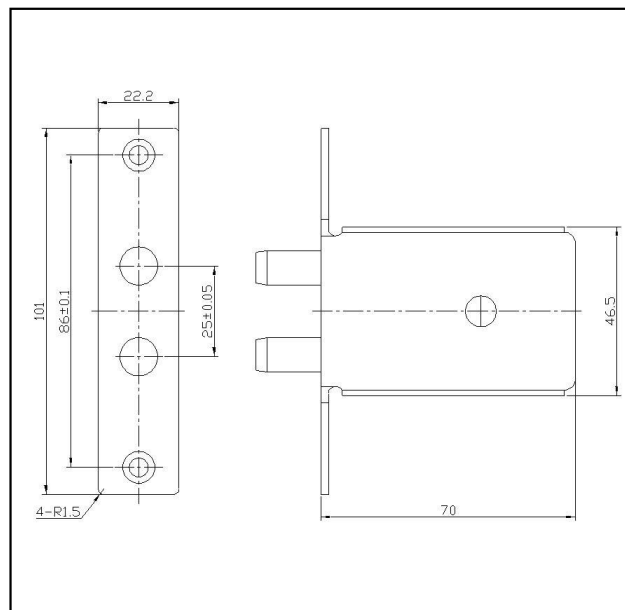

Backset 45mm

## Cylinder Mortise Lock



### DL2466 – Steel Mortise Deadbolt Lock

- 4 cylindrical deadbolts
- Steel forend
- 3 cross keys
- Backset 50mm
- Brass plated / Satin Nickel plated are available



## Cylinder Mortise Lock

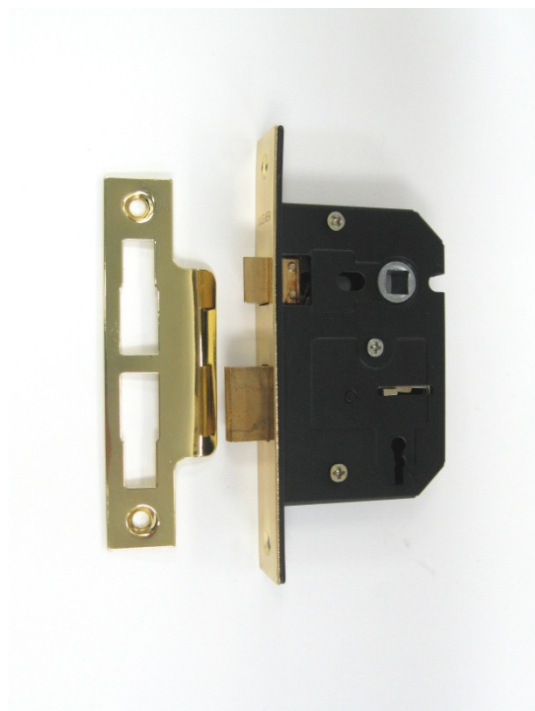

### DL3361 – Steel Mortise Lock

- Brass easy reverse latch and deadbolt
- Twins spring, one throw
- Bolt through fixing holes
- Steel forend
- 3 lever & 2 zinc alloy keys
- Size: 2-1/2" or 3"
- Brass plated / Chrome plated / Nickel plated forend are available

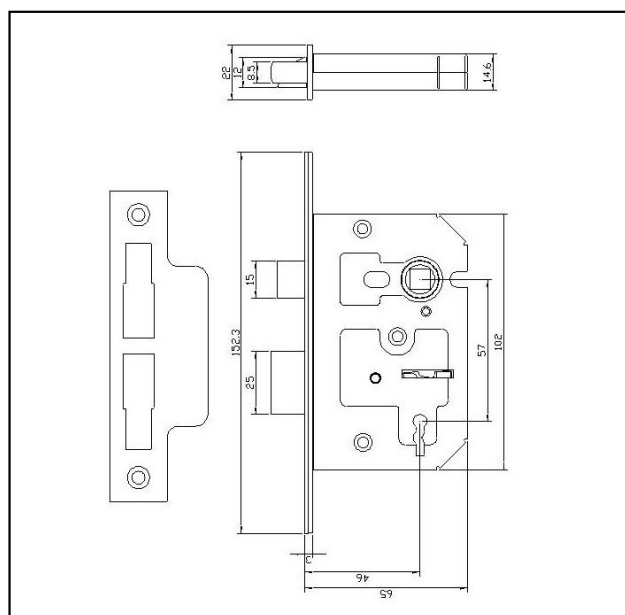

Backset 2-1/2"

## Cylinder Mortise Lock

### DL3870 – 3 Levers Mortise Lock



- Steel forend & lock case
- Zinc alloy latch & deadbolt
- with 2 zinc alloy keys
- Backset 55mm
- Chrome plated / Nickel plated forend are available

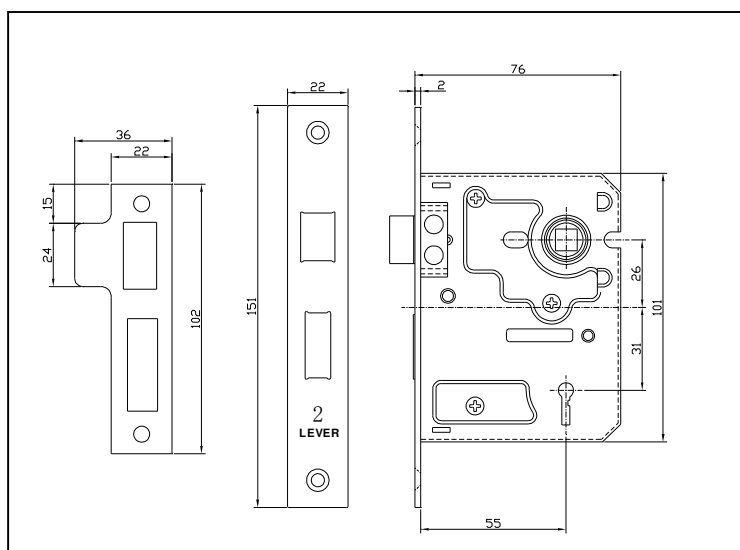

Backset 55mm

## Cylinder Mortise Lock

### DL3871 – 3 Levers Mortise Lock



- Steel forend & lock case
- Zinc alloy reversible latch & deadbolt
- with 2 zinc alloy keys
- Backset 55mm
- Chrome plated / Nickel plated forend are available

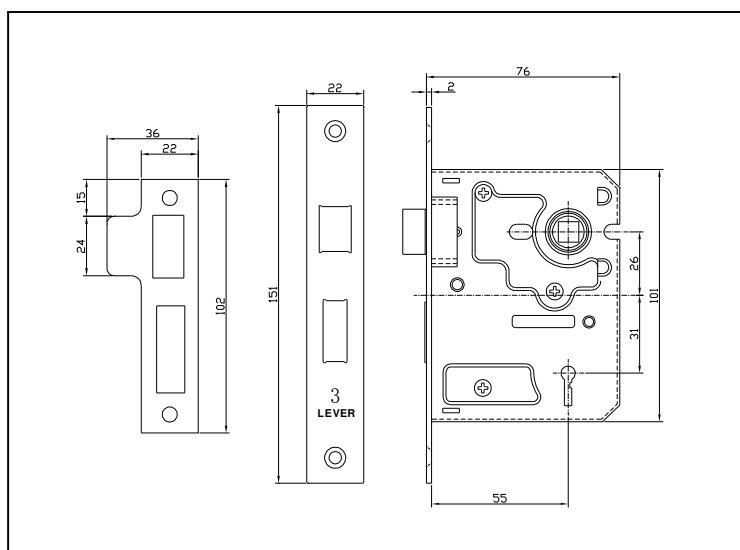

Backset 55mm

## Cylinder Mortise Lock



### DL1911 – Swing Up Deadbolt

- Double Mortise Cylinder
- With Normal Bolt
- Flat / Radius Faceplate
- Backset: 31/32" or 1-1/8"
- Satin Aluminium / Duronodic

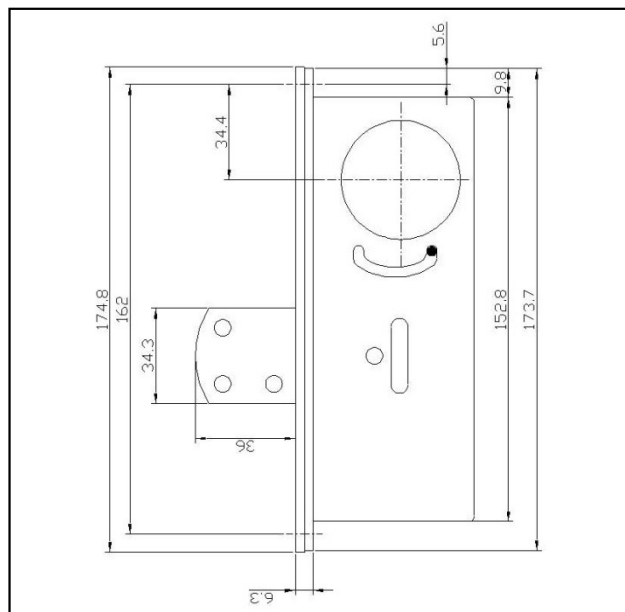

Backset 2-1/2"

## Cylinder Mortise Lock



### DL1912 – Swing Up Deadbolt

- Double Mortise Cylinder
- With Hook Bolt
- Flat / Radius Faceplate
- Backset: 31/32" or 1-1/8"
- Satin Aluminium / Duronodic

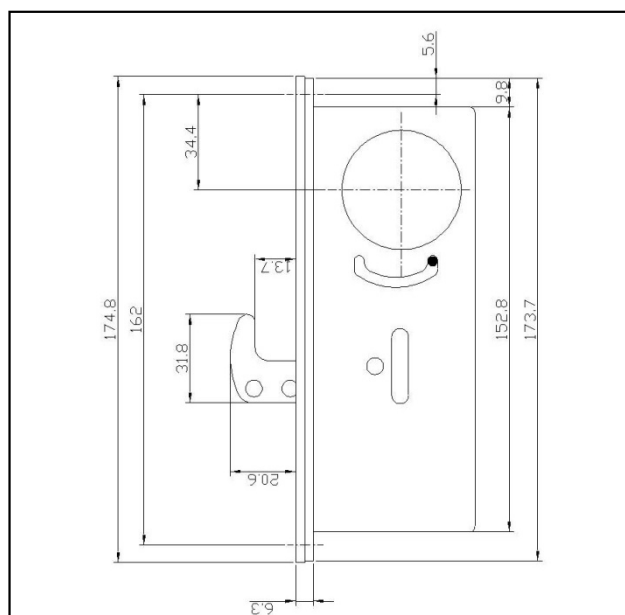

Backset 2-1/2"